

QUEENSTOWN GARDENS DRAFT DEVELOPMENT PLAN

RESET
URBAN
DESIGN



CONSULTATION PRESENTATION
OCTOBER 2017

PREPARED FOR QUEENSTOWN LAKES DISTRICT COUNCIL

TABLE OF CONTENTS

An aerial photograph of Queenstown Gardens, showing a large green park area with several tennis courts, a swimming pool, and a playground. The park is bordered by a body of water on the left and a residential area on the right. The text of the table of contents is overlaid on the left side of the image.

01	INTRODUCTION
02	CONTEXT
03	ANALYSIS
04	PLANNING PRINCIPLES
05	DRAFT DEVELOPMENT PLAN

01 INTRODUCTION



(Image sourced from www.itc.co.nz)

A development plan for the crown jewel of Queenstown.

“The Queenstown Gardens are sited on a small peninsular on the shoreline of Lake Wakatipu. It is considered one of the finest locations imaginable for a public garden.”

Queenstown Gardens Reserves Management Plan 2011

Quick Statistics:

- Total Area - 14.75ha
- 7 Scheduled trees
- January 1867 declared a reserve for public purposes - 150 years old 2017
- 100,000 visits every month and increasing

Strategic Objectives:

- Create a development plan to manage change
- Outline a costed staged capital investment
- Increase accessibility
- Manage conflicts with different uses
- Preserve heritage
- Rationalise layout & facilities

02
CONTEXT
HISTORY

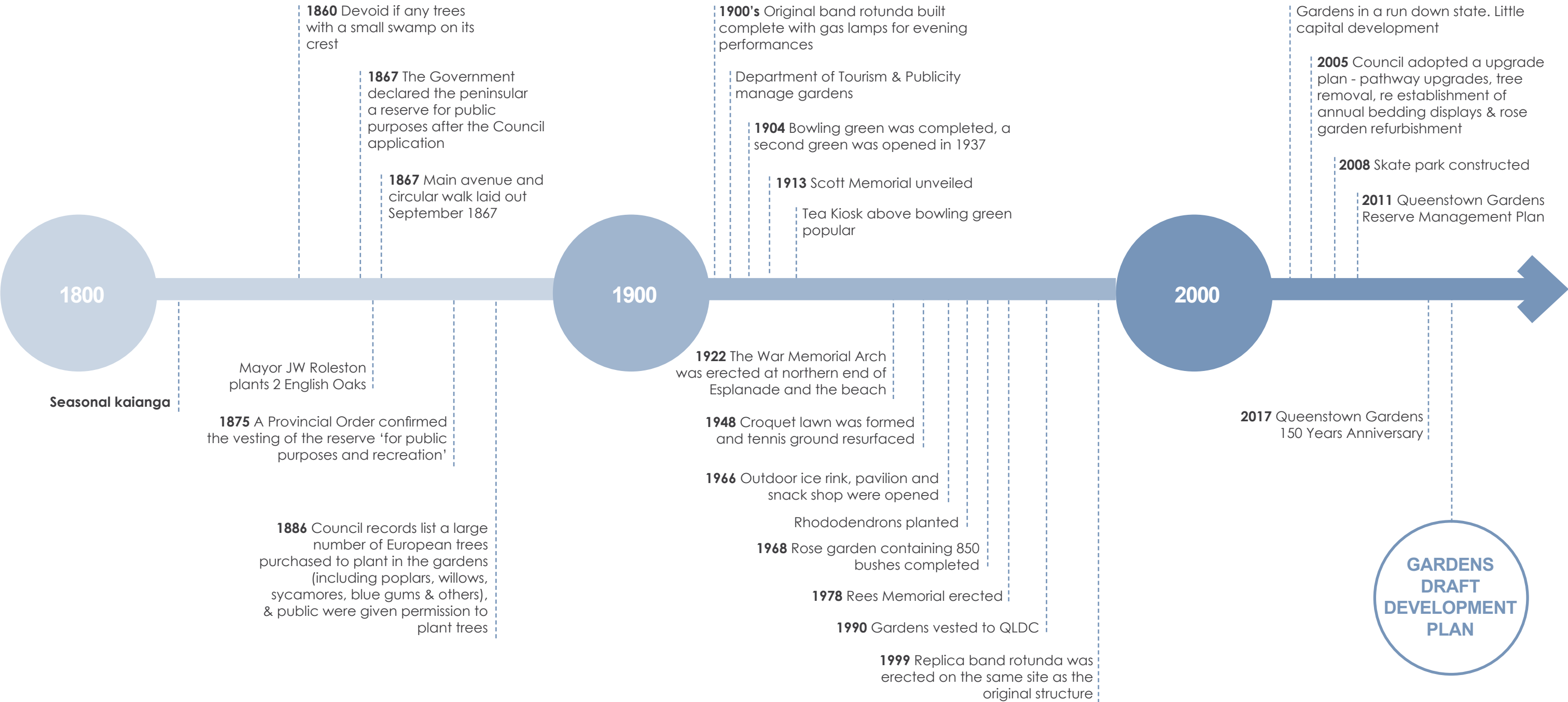

02
CONTEXT
HISTORY

The Queenstown Gardens
are integral to the history of
Queenstown.

Having been established in 1887 by members of the town's first Borough Council. It is considered one of the finest locations imaginable for a public garden. Due to the proximity to the busy commercial centre of Queenstown, the Gardens have become a focal point for locals and visitors who value the opportunity to relax in peaceful surroundings and enjoy the magnificent lake and mountain views.



Queenstown Gardens (1947)

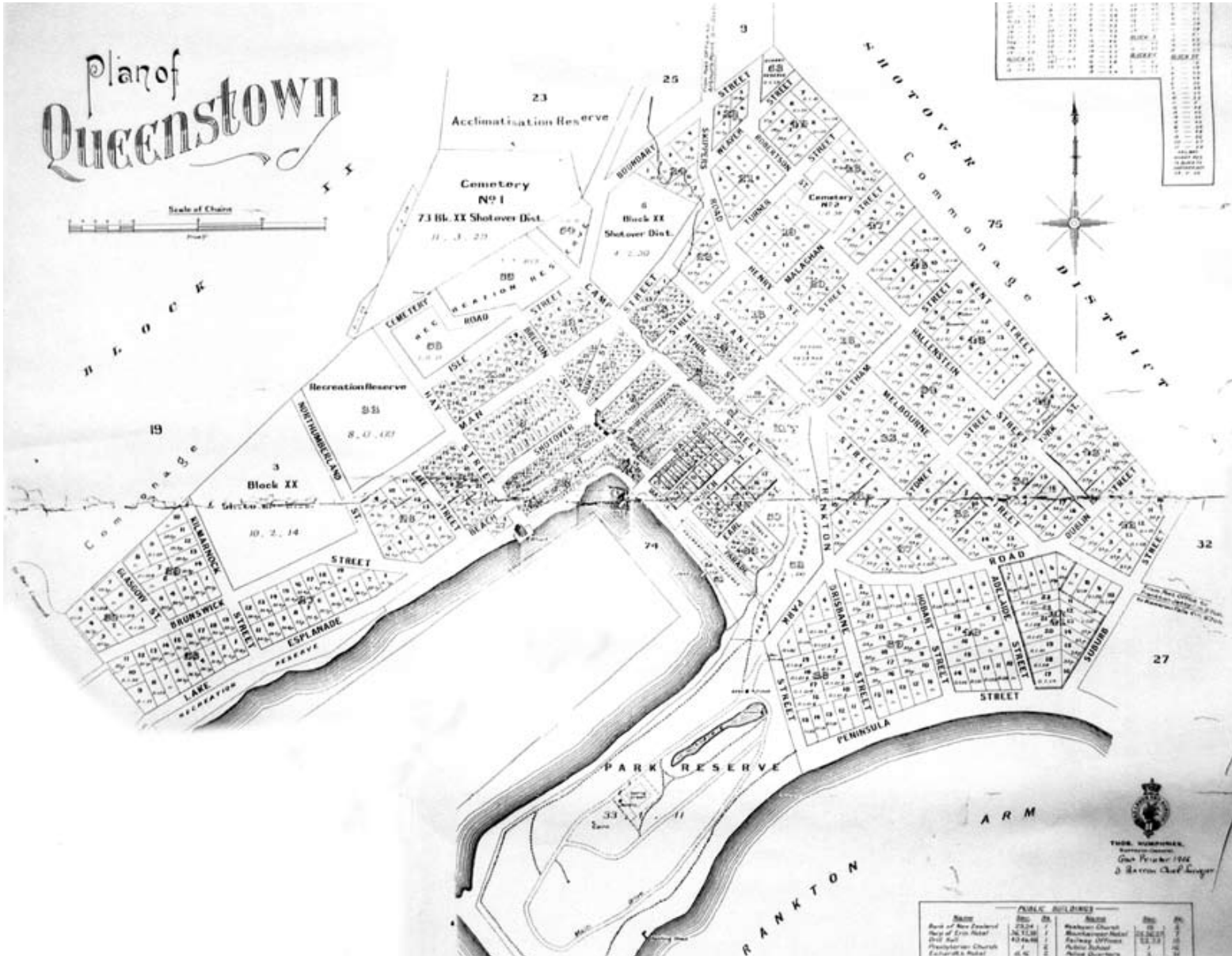

Early Title Map of Queenstown (Source: Lakes District Museum)



Robert Scott Memorial (1917)



Wooden Footbridge (1930)



Bowling Green



Band Rotunda



Entry Gate



Band Rotunda (1914)

02 CONTEXT BENCHMARKS

BOTANICAL GARDENS (NEW ZEALAND)

Associated with a national family of urban parks

Common Elements:

- Entry gates
- Formal rose gardens and flower bed displays
- Feature gardens (i.e. Rhododendron's, Orchids, Daffodil lawns, fragrant gardens, fernery, woodland gardens, herbaceous borders, winter gardens)
- Trellis arbors and pergolas
- Band Rotunda's
- Specimen tree collections
- Constructed ponds and fountains including mirror ponds
- Bowling and Croquet lawns
- Memorials and monuments
- Infrastructure (i.e. toilets, maintenance depot and nursery area)

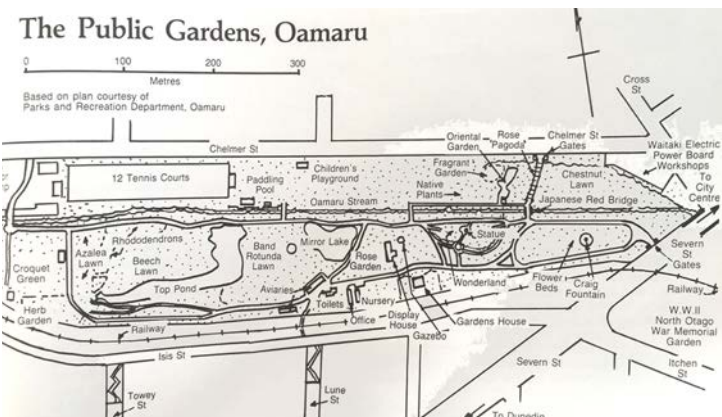
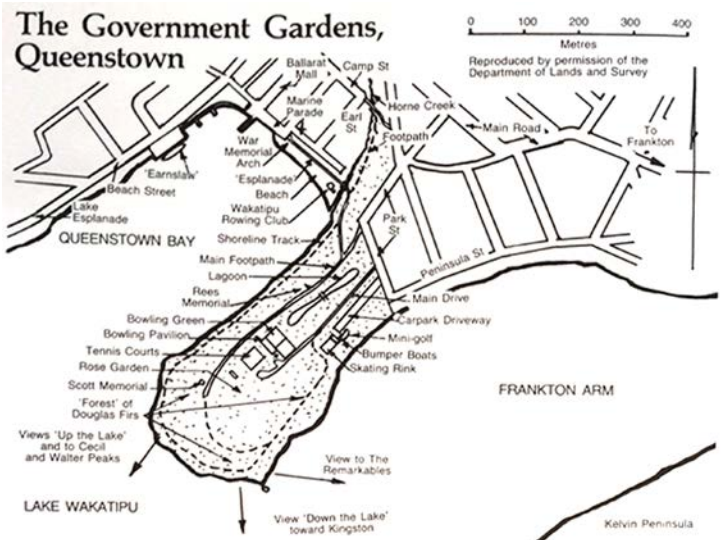
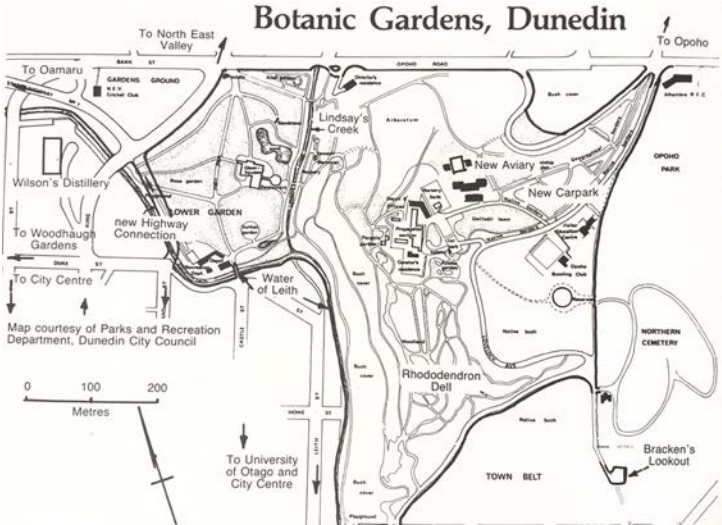
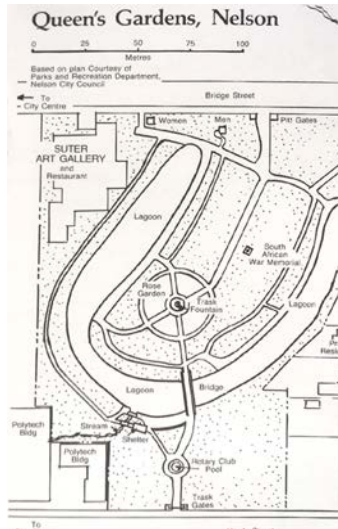
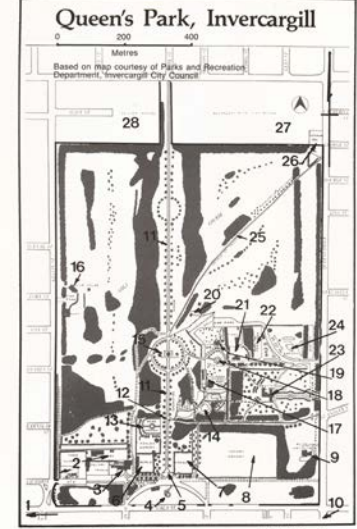
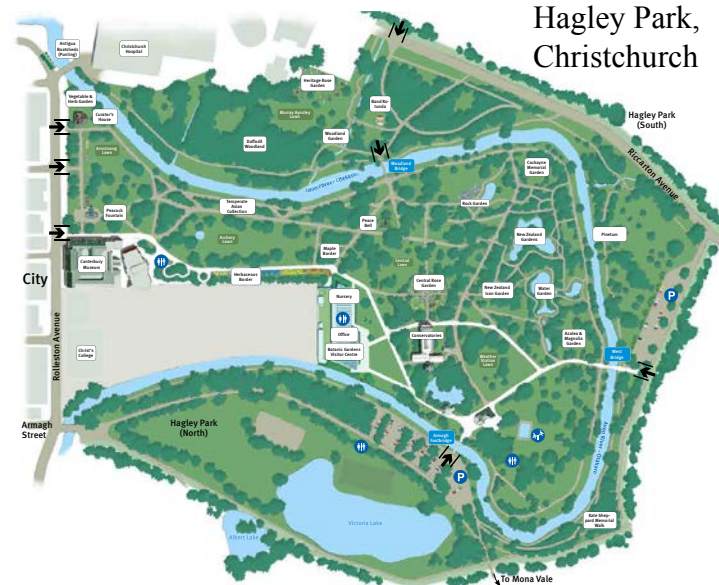

PUBLIC GARDENS (INTERNATIONAL)

Renewed interest in large botanic gardens / 95 Iconic destinations

Common Elements:

- Walking & cycling promenades
- Both destinations and landmarks
- Open grass areas for passive recreation
- Seasonal plantings
- Tree framework
- Public amenities (toilets, food, shade, water etc)
- Variety of spaces & activities
- Multiple path networks and connections
- Engaging sensory environment



Floral displays - Eden Garden, UK



Demonstration gardens - The Herb Garden, Brooklyn



Artwork - Royal Botanical Gardens, Wisconsin



Seasonal exhibits - Gardens by the Bay, Singapore



Education - Longwood Botanical Gardens, Pennsylvania



Events - Gardens by the Bay, Singapore

02 CONTEXT MANAGEMENT PLANS

QUEENSTOWN BAY FORESHORE RESERVES MANAGEMENT PLAN 2016



This Management Plan seeks to provide appropriate objectives and policies to strike a balance between preserving the area for future recreation use by residents and visitors and allowing a lowlevel of innovative commercial activity that is characteristic of the Queenstown environment. The vision for Queenstown Bay Foreshore Reserves Management Plan is to manage and maintain the Queenstown Bay Foreshore Reserves to:

- Encourage their use for recreation,
- Enhance amenity values of foreshore park areas.
- Preserve the natural character of the transition between the reserve areas and the lake.
- Advocate that surrounding activities and land use do not adversely affect the amenity and values of the reserves or the lake.

Zone 4: Horne Creek to head of Queenstown Gardens
Primary Objectives:

- promote use of area for passive recreation
- enhance the ecological values of the area
- phase out inappropriate planting species / ecological restoration

QUEENSTOWN GARDENS RESERVE MANAGEMENT PLAN 2011



- The management plan was prepared to enable the Council to establish the desired mix of uses for the Queenstown Gardens and set in place policy to guide future day to day management of the Gardens.
- Focus on management policies and general maintenance/up-keep of Gardens
- The management plan is not a development plan
- Classified as a recreation reserve?
- Can be updated every 10 years
- Valued as a tranquil garden adjacent to a busier town centre
- Facilitate use for active & passive recreation, and events that do not compromise the use
- Provide a diverse range of recreation, education & leisure activities

03 ANALYSIS - CONSTRAINTS

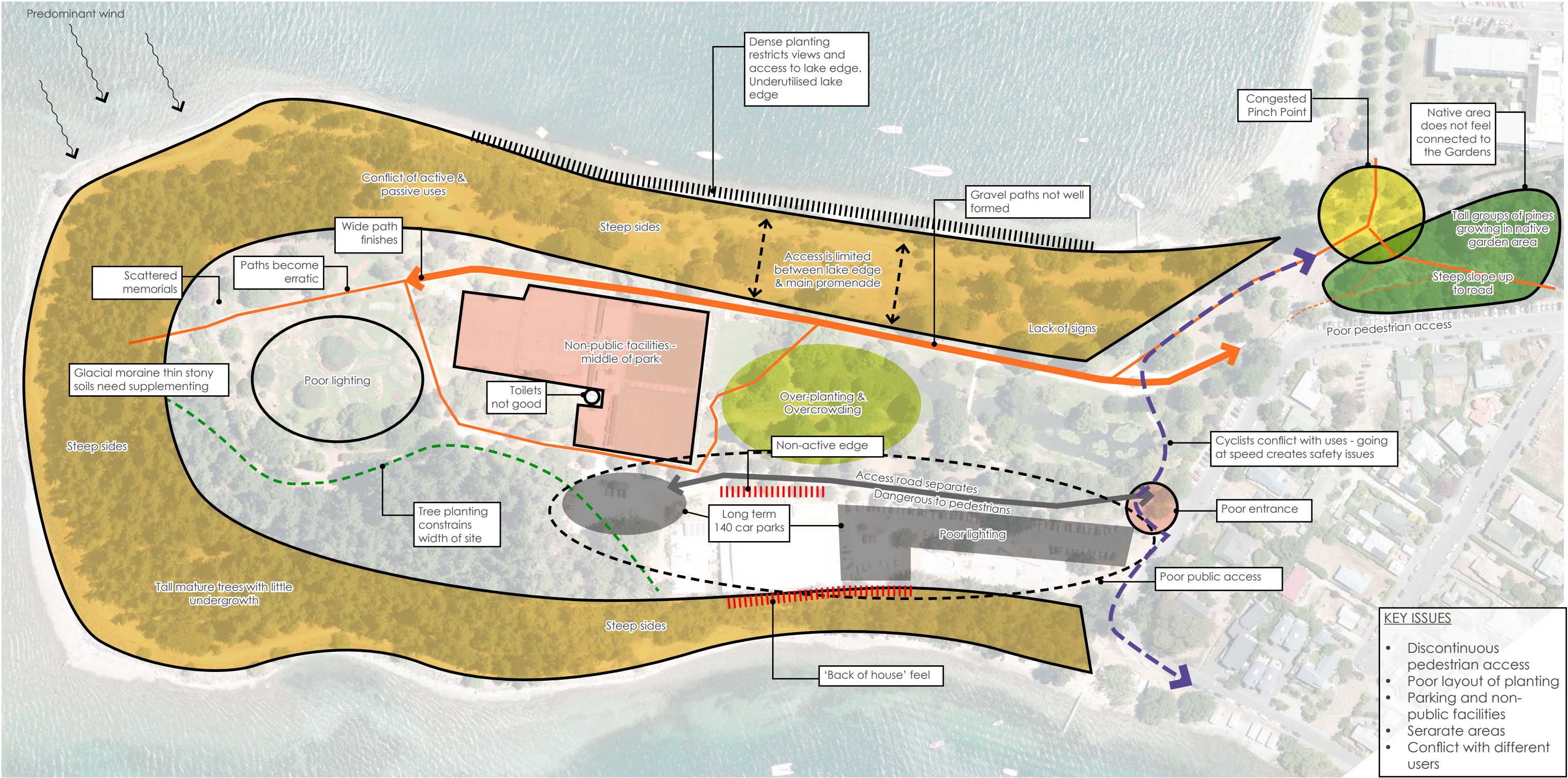

03 ANALYSIS - OPPORTUNITIES

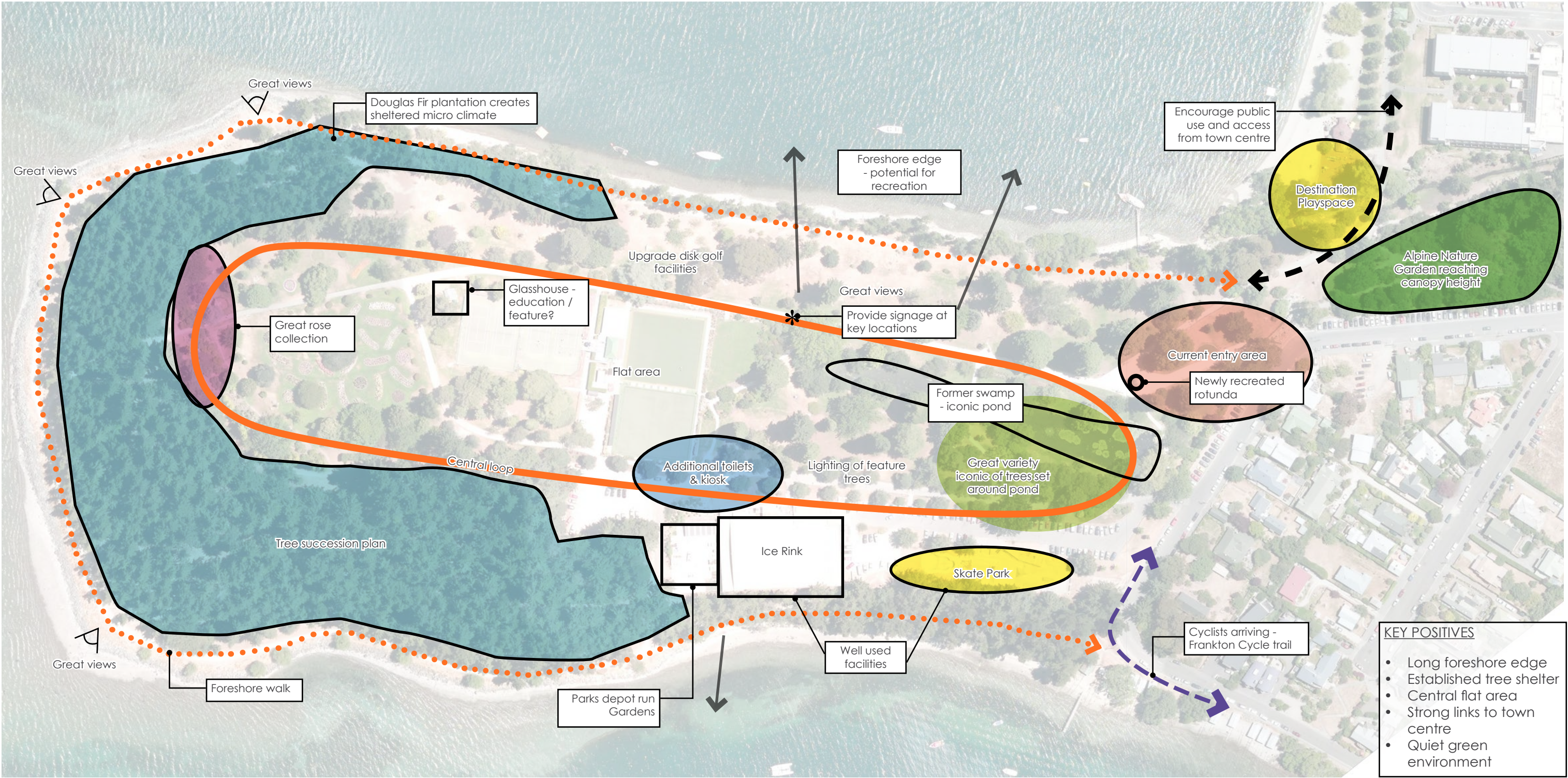

04 PLANNING PRINCIPLES

IMPROVING CONNECTIVITY BETWEEN THE GARDENS AND THE TOWN CENTRE, AND CIRCULATION WITHIN THE GARDENS

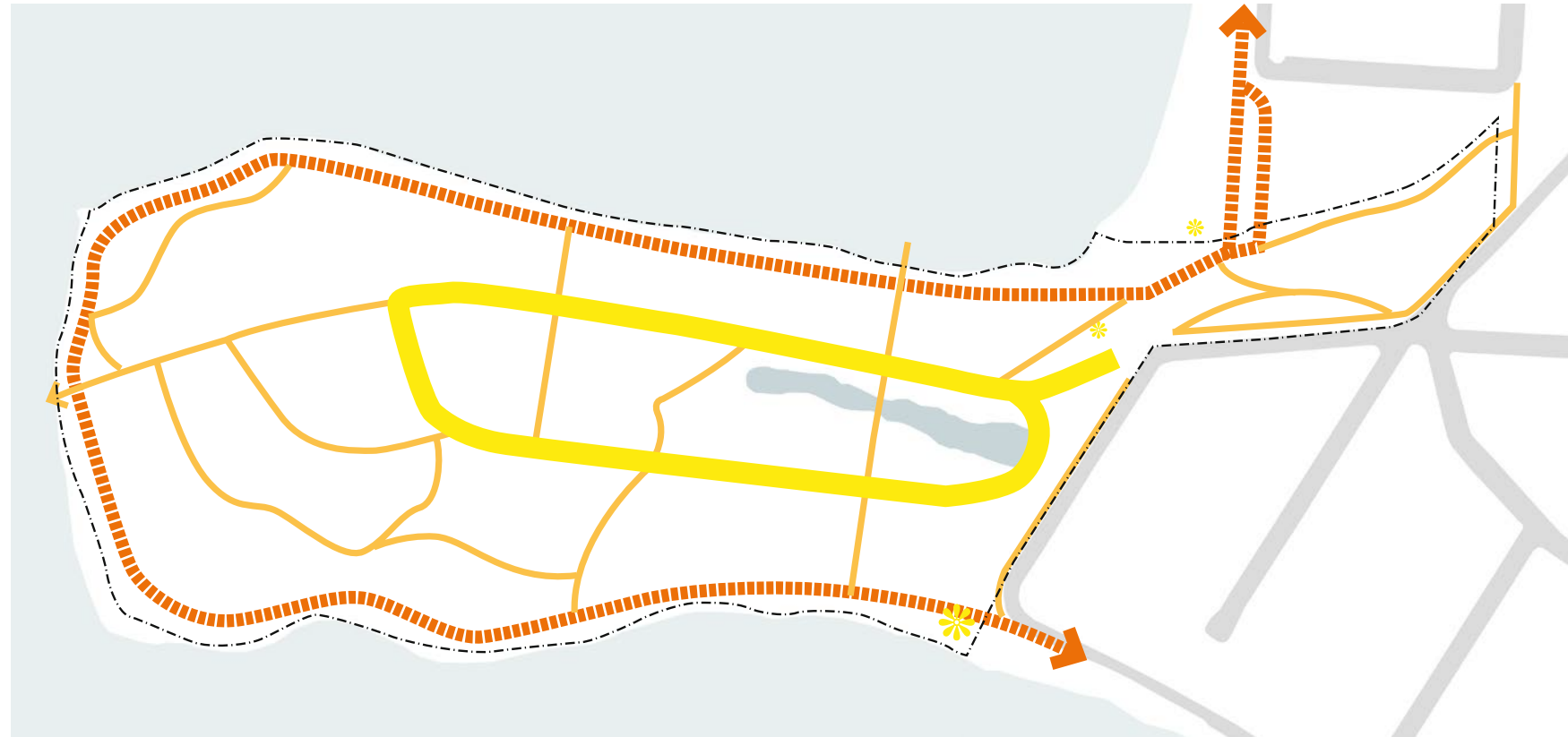

Big Moves

- Re -create a series of looped pathways
- Connect network of paths across peninsular
- Additional crossings of Horne Creek
- Separate cycleway along Park St
- Wide well formed aggregate paths



04 PLANNING PRINCIPLES

IMPROVING PUBLIC SAFETY AND WAY FINDING (INCLUDING LIGHTING, ACCESS ROAD, STANDARD OF PATHS)



- Big Moves
- Comprehensive lighting plan implemented
 - Re align access road
 - System of directional signage
 - Legible zones & theme gardens



04 PLANNING PRINCIPLES

EFFICIENT USE FOR ALL USERS - ACCOMMODATE A VARIETY OF ACTIVITIES, FACILITIES AND EVENTS THAT CATER FOR AND ARE COMPATIBLE WITH THE PARKS PASSIVE AND RECREATION USE TOGETHER WITH ITS COMMUNITY FOCUS AS A PREMIER PARK

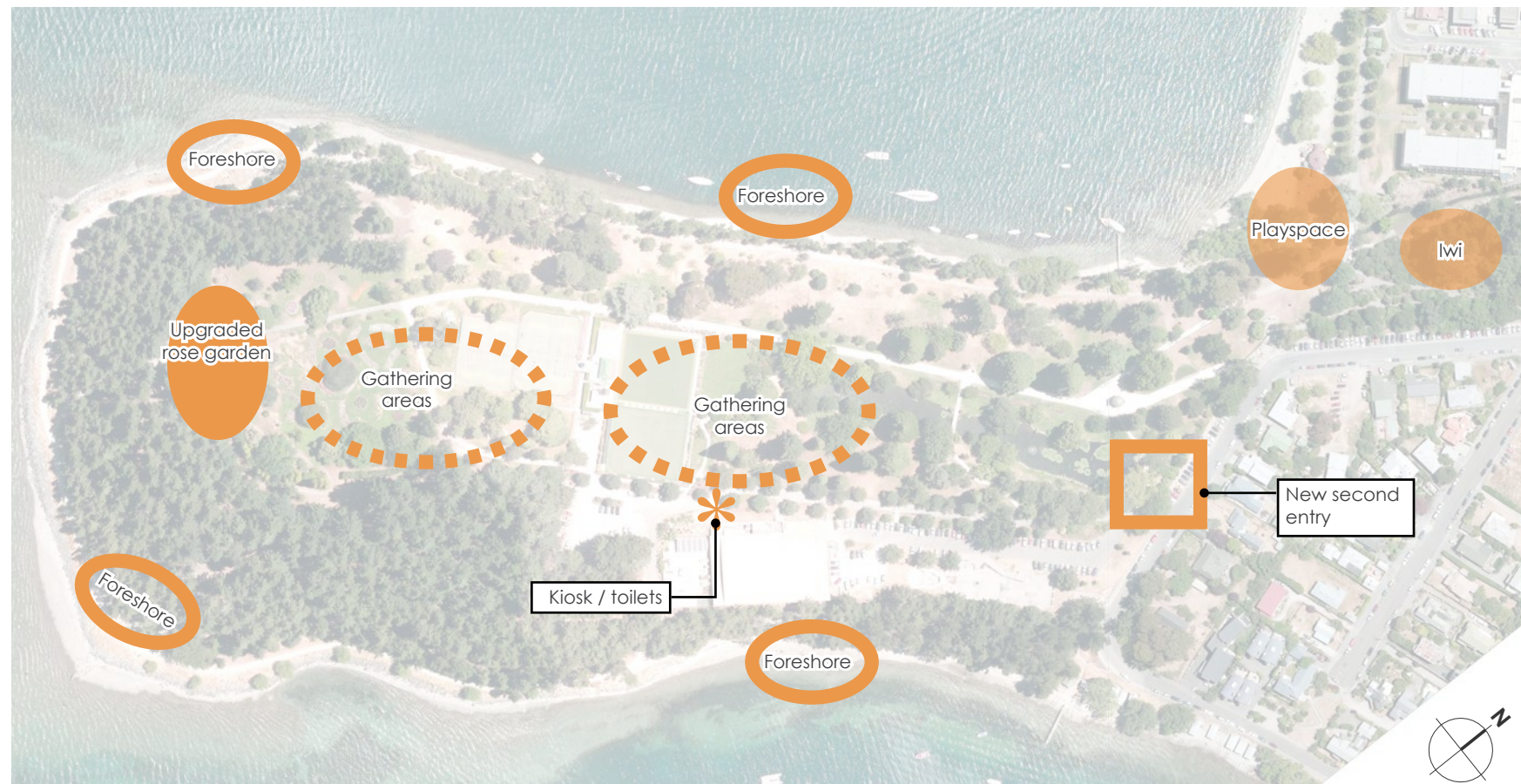

Big Moves

- Destination playground
- Enhance native garden with lwi
- Engage with foreshore
- Add kiosk / toilet and info centre
- Create spaces for gatherings



04 PLANNING PRINCIPLES

RECOGNISING THE UNIQUE HERITAGE AND SUPPORTING EXISTING FEATURES AND USES – INCLUDING EDUCATION, ACCESS AND LEASES



- Big Moves
- Interpretive signage
 - Educational facility
 - Supporting existing leases
 - Protect heritage structures



04 PLANNING PRINCIPLES

ENHANCING THE ECOLOGY, PLANNING FOR VEGETATION AND TREE SUCCESSION



Big Moves

- Create succession plan for trees
- Maintain woodland shelter belt
- Structure planting framework
- Series of theme gardens & areas
- Reduce high maintenance flower beds
- Introduce productive gardens



05

DRAFT DEVELOPMENT PLAN

EXISTING SITE



- 01

Douglas Fir plantation (Woodland)
- 02

Lakeside Pathway
- 03

Disc golf area
- 04

Existing memorials
- 05

Rose Gardens
- 06

Greenhouse
- 07

Tennis Courts
- 08

Bowling & Tennis Clubrooms
- 09

Public Toilets
- 10

Private Car park
- 11

Bowling Greens
- 12

Public Car park (35 spaces)
- 13

Croquet Lawn
- 14

Gardens Maintenance Depot
- 15

Ice Arena
- 16

Feature Ponds
- 17

Feature Pond Bridge
- 18

Rees Memorial
- 19

Annual Bedding Display
- 20

Skate Park
- 21

Public Car Park (67 spaces)
- 22

Boat Sheds
- 23

Band Rotunda & Plaza
- 24

Car Park Entrance
- 25

Pedestrian Entrance & Gate
- 26

Main Entrance via Bridge from Marine Parade
- 27

Native Planting Area

05

DRAFT DEVELOPMENT PLAN

PLAN



KEY MOVES

- Start of native planting, removal of selected existing trees & tree succession
- Memorial arbor
- Pedestrianisation of exiting central access lane
- New iSite / Public Toilets / Plaza
- Service lane / access to bowls & overflow parking
- New seating and steps down to lakeside pathway

- New display gardens - eastern side of pond
- Upgraded playspace - under way
- Cycle link
- Relocation of car park entrance
- New entry arch and entry feature
- Removal of tall Douglas Fir between Novotel & Park St, with native planting & lwi installation

01

Woodland (Start of Successional Planting to remove Douglas Fir)

02

Native Succession Planting & Gardens

03

Lakeside Pathway - mainly existing with some upgrades to western sections

04

Existing Lookout Points

05

Sound shell structure

06

Existing Memorials & New Memorial Arbor

07

Reconfigured Rose Gardens

08

Tennis Courts

09

Bowls & Overflow Parking

10

Bowling & Tennis Clubrooms

11

Bowling Greens

12

Gardens Maintenance Depot

13

Ice Arena

14

Info / Public Toilets / Cafe

15

Plaza Space & Seating

16

Display Gardens

17

New Steps / Access

18

Feature Ponds & Bridge

19

Rees Memorial

20

Annual Bedding Displays

21

Existing Band Rotunda

22

Pedestrian Entrance & Gate

23

Main Entrance via Bridge from Marine Parade

24

Upgraded / New Playground

25

New Pedestrian Entry Arch & Rotunda

26

Public Car Park (67 spaces)

27

Skate Park

28

Boat Sheds

29

Removal of large Douglas Fir

30

Native Planting & lwi Installation

QUEENSTOWN GARDENS

DRAFT DEVELOPMENT PLAN

16

RESET URBAN DESIGN

QUEENSTOWN LAKES DISTRICT COUNCIL

05
DRAFT DEVELOPMENT PLAN
CROSS SECTION A

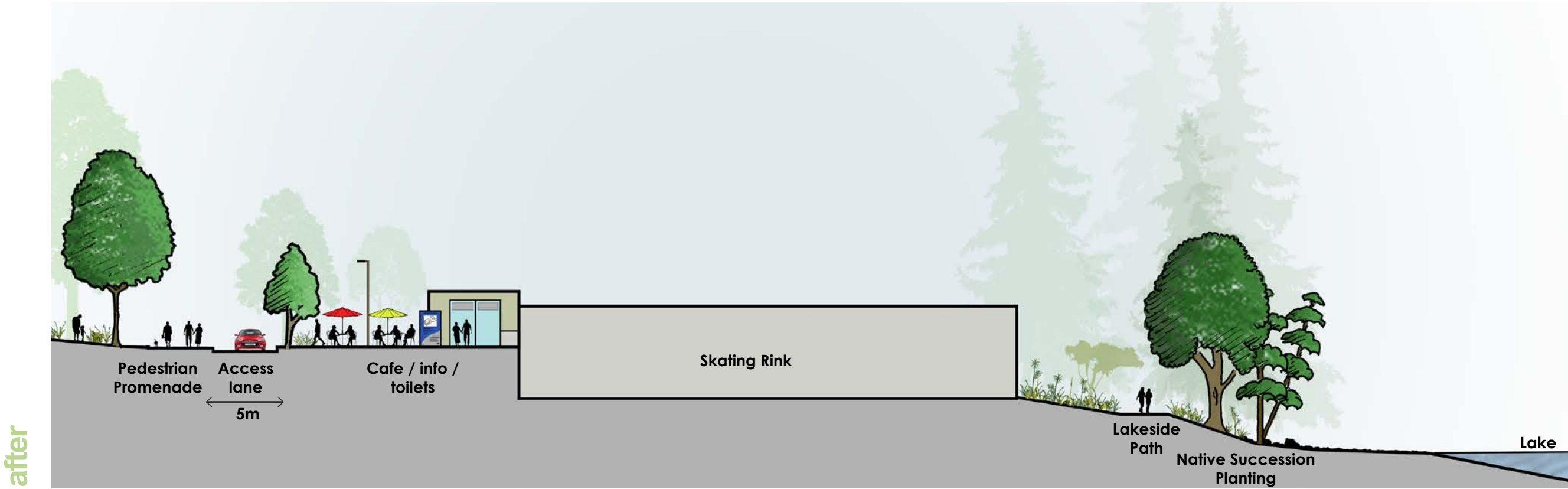
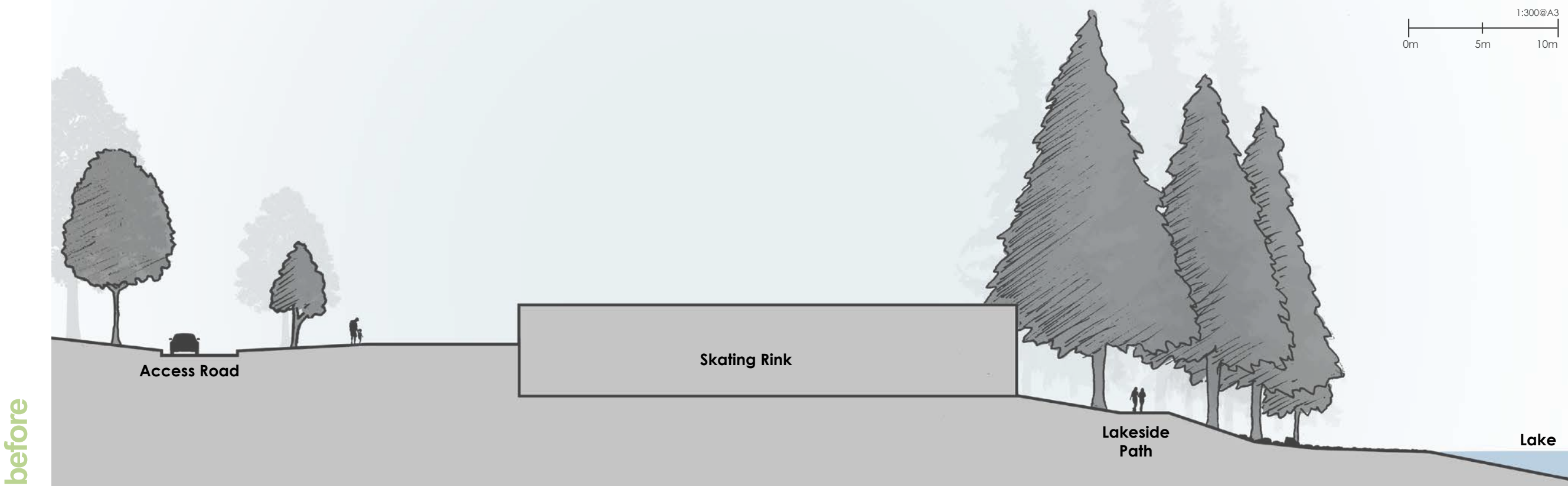

05
DRAFT DEVELOPMENT PLAN
CROSS SECTION B

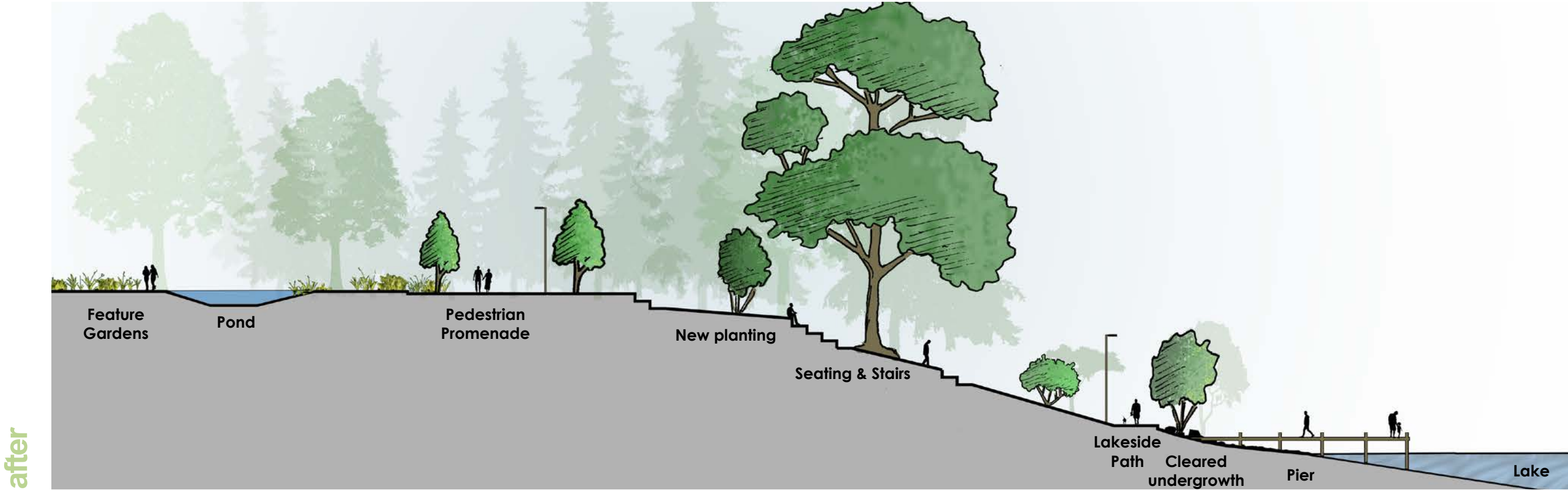

05
DRAFT DEVELOPMENT PLAN
PERSPECTIVE 1



05 DRAFT DEVELOPMENT PLAN PERSPECTIVE 2



05 DRAFT DEVELOPMENT PLAN PERSPECTIVE 3

