

**RECORD OF TITLE  
UNDER LAND TRANSFER ACT 2017  
FREEHOLD  
Search Copy**



  
R.W. Muir  
Registrar-General  
of Land

**Identifier** OT5C/21  
**Land Registration District** Otago  
**Date Issued** 22 August 1973

**Prior References**

OT5A/269

---

<b>Estate</b>	Fee Simple
<b>Area</b>	1.2141 hectares more or less
<b>Legal Description</b>	Lot 1 Deposited Plan 12822 and Lot 16 Deposited Plan 12921

**Registered Owners**

Roland Gilbert Fernand Charles Lemaire-Sicre and Keri Paraniahia Lemaire-Sicre

---

**Interests**

Subject to Section 36 (4) Counties Amendment Act 1961

Appurtenant hereto is a right to convey water over part Sections 14 CT OT5A/277, 45, 46 and 50 CT OT5C/22 and 47 CT OT5A/267 Block III Shotover District created by Transfer 409093

Fencing Provision in Transfer 409093

474208 Gazette Notice declaring the State Highway No.6 adjoining the within land to be a limited access road from 14th December 1976 - 4.3.1977 at 10.18 am

5002336.3 Mortgage to Southland Building Society - 23.5.2000 at 9:00 am

Land Covenant in Transfer 7374945.1 - 17.5.2007 at 9:00 am

Land Covenant in Easement Instrument 9976264.1 - 14.4.2015 at 3:59 pm

Land Covenant in Easement Instrument 10855629.3 - 19.12.2017 at 1:40 pm

Land Covenant in Easement Instrument 10855629.4 - 19.12.2017 at 1:40 pm

Land Covenant in Easement Instrument 11145861.4 - 17.8.2018 at 4:07 pm

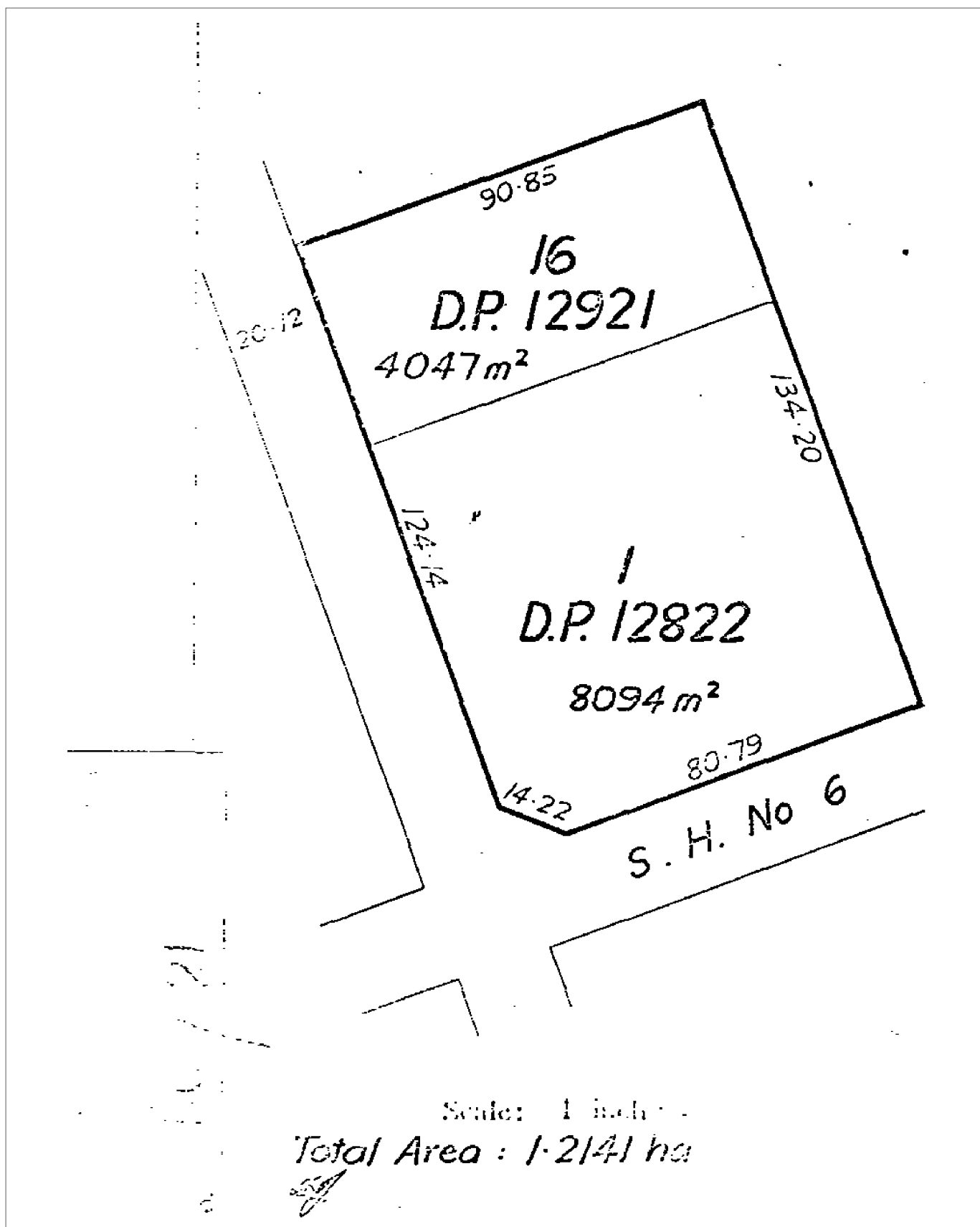

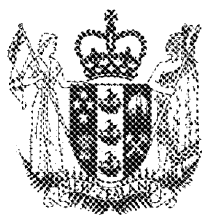

**RECORD OF TITLE  
UNDER LAND TRANSFER ACT 2017  
FREEHOLD  
Search Copy**



  
R.W. Muir  
Registrar-General  
of Land

**Identifier** OT5C/22  
**Land Registration District** Otago  
**Date Issued** 22 August 1973

**Prior References**

OT5A/268 OT5A/269

---

<b>Estate</b>	Fee Simple
<b>Area</b>	6.2721 hectares more or less
<b>Legal Description</b>	Section 51, Part Section 45-46 and Part Section 50 Block III Shotover Survey District

**Registered Owners**

Kinloch Downs Limited

---

**Interests**

Subject to Section 36 (4) Counties Amendment Act 1961

Subject to a right to convey water over part appurtenant to Lot 1 DP 12822 and Lot 16 DP 12921(CT OT5C/21)  
created by Transfer 409093

474208 Gazette Notice declaring the State Highway No 6 adjoining the within land to be a limited access road  
from 14th December 1976 - 4.3.1977 at 10.18 am

Fencing Covenant in Transfer 842250.1 - 9.11.1993 at 10.20 am

Subject to a right to take water and convey electricity over part Section 51 herein marked A and convey water  
marked B on DP 350296 created by Easement Instrument 6649305.2 - 16.11.2005 at 9:00 am

Land Covenant in Transfer 7374945.1 - 17.5.2007 at 9:00 am

9805229.4 Mortgage to ANZ Bank New Zealand Limited - 4.9.2014 at 1:45 pm

Land Covenant in Easement Instrument 11079143.1 - 25.5.2018 at 9:22 am

**TITLE DIAGRAM OT5C/2:**

Cpy - 01/01, Pgs - 001, 24/02/08, 14:18



DocID: 100252801

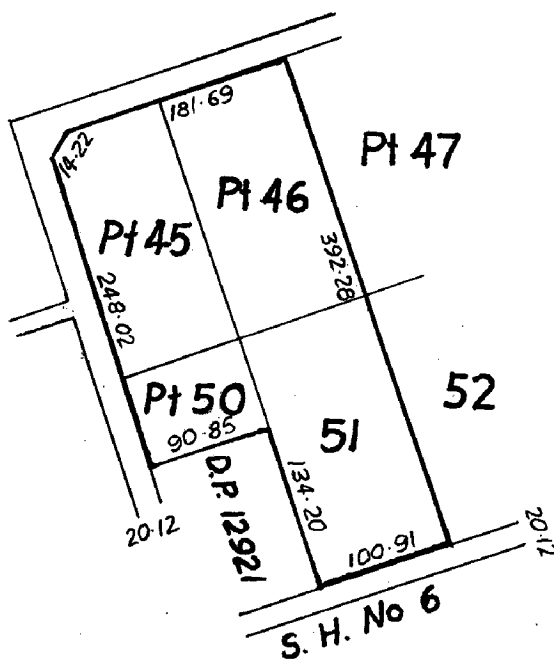

Area: 6.2721 ha.