

Open Space and Recreation Zone Variations

Key: Underlined text for additions and strike through text for deletions Variation to Stage 1 PDP Chapter 2.

NEW AND AMENDED STAGE 3 PDP PROVISIONS, ADDED TO STAGE 2 CHAPTER 38 OPEN SPACE AND RECREATION ZONES CHAPTER

38.1 Rules – Activities

Rule	Activities	Nature Conservation Zone	Informal Recreation Zone	Active Sports/ Recreation Zone	Civic Spaces Zone	CPZ	CPZ (Golf)	CPZ (Camping Ground)	CPZ (Cemeteries)
38.9.16	<p>Restaurants and cafes that are accessory to a permitted activity and are located further than 50m from a Residential Zone including buildings.</p> <p><u>This Rule does not apply to buildings that are located on jetties that extend into the Queenstown Bay Waterfront Subzone. These buildings are subject to Rule 12.4.8.2.</u></p>	NC	C	C	C	C	C	C	NC

Rule	Activities	Nature Conservation Zone	Informal Recreation Zone	Active Sports/ Recreation Zone	Civic Spaces Zone	CPZ	CPZ (Golf)	CPZ (Camping Ground)	CPZ (Cemeteries)
38.9.17	Restaurants and cafes that are accessory to a permitted activity and are located within 50m of a Residential Zone including buildings. <u>This Rule does not apply to buildings that are located on jetties that extend into the Queenstown Bay Waterfront Subzone. These buildings are subject to Rule 12.4.8.2.</u>	NC	RD	RD	RD	RD	RD	RD	NC
38.9.19b	<u>Commercial outdoor dining on land that adjoins the Active Frontage Area of the Queenstown Bay Waterfront Subzone (Rule 38.10.14) and is not provided for elsewhere in this table.</u>	NA	RD	NA	RD	NA	NA	NA	NA
38.9.20	Commercial Recreation Activities and buildings associated with Commercial Recreation Activities. <u>This Rule does not apply to buildings that are located on jetties that extend into the Queenstown Bay Waterfront Subzone. These buildings are subject to Rule 12.4.8.2.</u>	D	D	D	RD	RD	RD	RD	NC

Rule	Activities	Nature Conservation Zone	Informal Recreation Zone	Active Sports/ Recreation Zone	Civic Spaces Zone	CPZ	CPZ (Golf)	CPZ (Camping Ground)	CPZ (Cemeteries)
38.9.21	Commercial Activities and buildings associated with, and located on the same site as recreation activities. <u>This Rule does not apply to buildings that are located on jetties that extend into the Queenstown Bay Waterfront Subzone. These buildings are subject to Rule 12.4.8.2.</u>	D	D	D	RD	RD	RD	RD	NC
38.9.36	Boat Ramps, Jetties and Marinas. <u>This Rule does not apply to jetties that extend into the Queenstown Bay Waterfront Subzone. These jetties are subject to Rules 12.4.7.1 and 12.4.8.1.</u>	D	D	D	D	D	D	D	NC

38.10 Rules - Standards for Open Space and Recreation Zones

	Table 38.2: Standards for Activities in the Open Space and Recreation Zones	Non- compliance Status
38.10.13	<p><u>Commercial outdoor dining located on the Civic Spaces Zone and Informal Recreation Zone that adjoin Active Frontage Area of the Queenstown Bay Waterfront Subzone</u></p> <p><u>Outdoor dining shall immediately adjoin the restaurant or café that it is associated with and shall not extend into the Civic Spaces Zone or Informal Recreation Zone by more than 5 m from the Queenstown Town Centre Zone boundary or beyond the side boundaries of the restaurant or café.</u></p>	<u>NC</u>

38.13 Matters of control for Controlled Activities identified in Table 38.1

The Council will reserve its control to the following matters when assessing a controlled activity resource consent application.

	Table 38.4: Matters of Control for Activities in the Open Space and Recreation Zones
38.13.1	<p>Rule 38.9.16: Restaurants and cafes that are accessory to a permitted activity and are located further than 50m from a Residential Zone in the Civic Spaces Zone, Informal Recreation Zone, Active Sports and Recreation Zone, CPZ, CPZ (Golf), CPZ (Camping Ground):</p> <ol style="list-style-type: none"> Scale and intensity of the activity on recreation use and amenity values; Public access to, and use of the open space; Traffic generation, access and parking; and Infrastructure and servicing, including the provision of storage and loading/service areas; <u>and</u> <u>In the Civic Spaces Zone that adjoins the Arrowtown, Wanaka, and Queenstown Town Centre zones, and in that part of the Community Purposes Zone within 70 m of the Queenstown Bay Waterfront Subzone:</u> <ol style="list-style-type: none"> <u>external appearance, including materials and colours and associated landscaping;</u> <u>lighting;</u> <u>the contribution the building makes to the safety of the Town Centre through adherence to CPTED principles; and</u> <u>natural hazards.</u>

38.14 Matters of discretion for Restricted Discretionary Activities identified in Table 38.1

The Council will restrict its discretion over the following matters when assessing a restricted discretionary activity resource consent application.

	Table 38.5: Matters of Discretion for Activities in the Open Space and Recreation Zones
38.14.1	<p>Rule 38.9.17: Restaurants and cafes that are accessory to a permitted activity and are located within 50m of a Residential Zone in the Civic Spaces Zone, Informal Recreation Zone, Active Sports and Recreation Zone, CPZ, CPZ (Golf), CPZ (Camping Grounds):</p> <ul style="list-style-type: none"> a. Intensity and scale of the activity on recreation use and amenity values; b. Public access to, and use of, the open space; c. Location, in particular distance from adjoining properties; d. Traffic generation, access and parking; e. Noise; and f. Infrastructure and servicing, including the provision of storage and loading/service areas; <u>and</u> g. <u>In the Informal Recreation Zone that adjoins the Queenstown Bay Waterfront Subzone, and in the Civic Spaces Zone that adjoins the Arrowtown Town Centre Zone:</u> <ul style="list-style-type: none"> i. <u>external appearance, including materials and colours and associated landscaping;</u> ii. <u>lighting;</u> iii. <u>the contribution the building makes to the safety of the Town Centre through adherence to CPTED principles; and</u> iv. <u>natural hazards</u>
38.14.2	<p>Rules 38.9.20 and 38.9.21: Commercial recreation activity including commercial activities associated with and located on the same site as recreation activities, including buildings in the Civic Spaces Zone, CPZ, CPZ (Golf), CPZ (Camping Grounds):</p> <ul style="list-style-type: none"> a. Intensity and scale of the activity on recreation use and amenity values; b. Public access to, and use of the open space; c. Other occupiers or users of the site or adjoining sites; d. Traffic generation, access and parking; <u>and</u> e. <u>In the Civic Spaces Zone that adjoins the Arrowtown, Wanaka, and Queenstown Town Centre zones, and in those parts of the Informal Recreation and Community Purposes zones that are within 70 m of the Queenstown Bay Waterfront Subzone:</u> <ul style="list-style-type: none"> i. <u>external appearance, including materials and colours and associated landscaping;</u> ii. <u>lighting</u> iii. <u>the contribution the building makes to the safety of the Town Centre through adherence to CPTED principles; and</u> iv. <u>natural hazards</u>

	Table 38.5: Matters of Discretion for Activities in the Open Space and Recreation Zones
38.14.5	<p>Rule 38.9.19b: Commercial outdoor dining on the Civic Spaces Zone and Informal Recreation Zone, where the zone adjoins the Active Frontage Area of the Queenstown Bay Waterfront Subzone</p> <ul style="list-style-type: none"> a. <u>the scale of the activity;</u> b. <u>effects on the amenity of the reserve, including pedestrian access to and through it</u> c. <u>lighting;</u> d. <u>effects on the safety of the reserve through designing the outdoor space in accordance with CPTED principles;</u> e. <u>noise issues;</u> f. <u>hours of operation; and</u> g. <u>cumulative effects.</u>

VARIATION TO STAGE 1 CHAPTER 36 – NOISE

36.5.2	... Open space and Recreation Zone, <u>except the Civic Spaces Zone where it adjoins the Queenstown, Wanaka, or Arrowtown Town Centre zones</u>	Any point within any site	0800h to 2000h	50dBAeq (15 min)	NC
			2000h to 0800h	40dBAeq (15 min)	NC
36.5.2b	<u>Civic Spaces Zone where it adjoins the Queenstown, Wanaka, or Arrowtown Town Centre zones</u>	Any point within any site	0800h to 2200h	60 dB LAeq (15 min)	NC
			2200h to 0800h	50 dB LAeq (15 min)	NC

VARIATION TO STAGE 2 CHAPTER 29 – TRANSPORT

29.8 Minimum Parking Requirements Minimum Parking Requirements

	Table 29.4	Resident/ Visitor	Staff/ Guest
29.8.1	<p>All activities in the:</p> <ul style="list-style-type: none"> • Queenstown Town Centre Zone; • Wanaka Town Centre Zone; • Arrowtown Town Centre Zone; • Local Shopping Centre Zone; • Within the immediate environs of the Queenstown airport terminal facility located within the Airport Zone (Queenstown); • <u>Civic Spaces Zone, where it adjoins the Queenstown, Wanaka, or Arrowtown Town Centre Zones</u> • <u>Parts of the Community Purposes and Informal Recreation zones that are within 70 m of the Queenstown Bay Waterfront Subzone.</u> 	0	0

AMENDMENTS TO PLANNING MAPS 35 AND 36

Realign the QTWSZ boundary to exclude all land zoned OSZ.

1. Amend the location of the Queenstown Bay Waterfront subzone¹ boundary on Plan Maps 35 and 36 to exclude all OSZ from the QTWSZ, as follows:

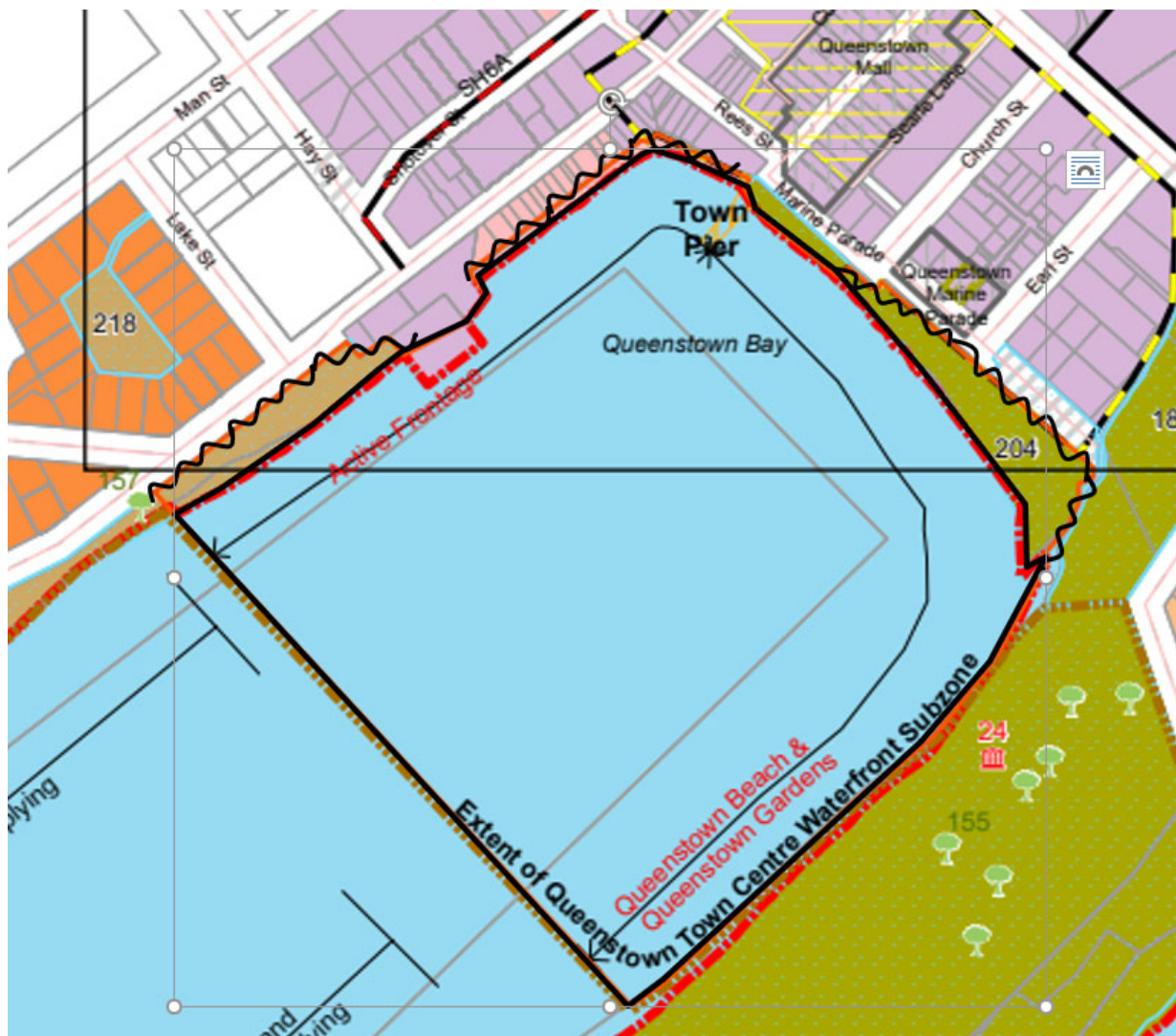

Figure 1 - Orange subzone boundary to be deleted and subzone boundary as shown in black to be added which excludes all OS zoned land from the waterfront subzone.

The location of the amended boundary is more clearly shown (in orange) on the below aerial:

¹ The references to “Queenstown Town Centre Waterfront subzone boundary” and “Queenstown Waterfront Zone” on the planning maps and the associated legend were amended to “Queenstown Bay Waterfront subzone” for consistency through the appeals to the QTTC zone – Topic 8)



Figure 2 – Amended QTWSZ boundary, as proposed by this Variation

2. Amend the zoning of those lots along the north-eastern edge of Earnslaw Park from QTTC to Civic Spaces zone to be consistent with the principle of chapter 38 that all council-owned reserve land (get wording from S 32) is zoned OSZ.



Figure 3 – QTTC Zone to be deleted from the area shown as pink with a bold black outline and replace with Civic Space Zone, as shown.

3. Amend the zoning of the slither of Rural zoned land between the CPZ (Queenstown Gardens) and QTWSZ to CPZ.

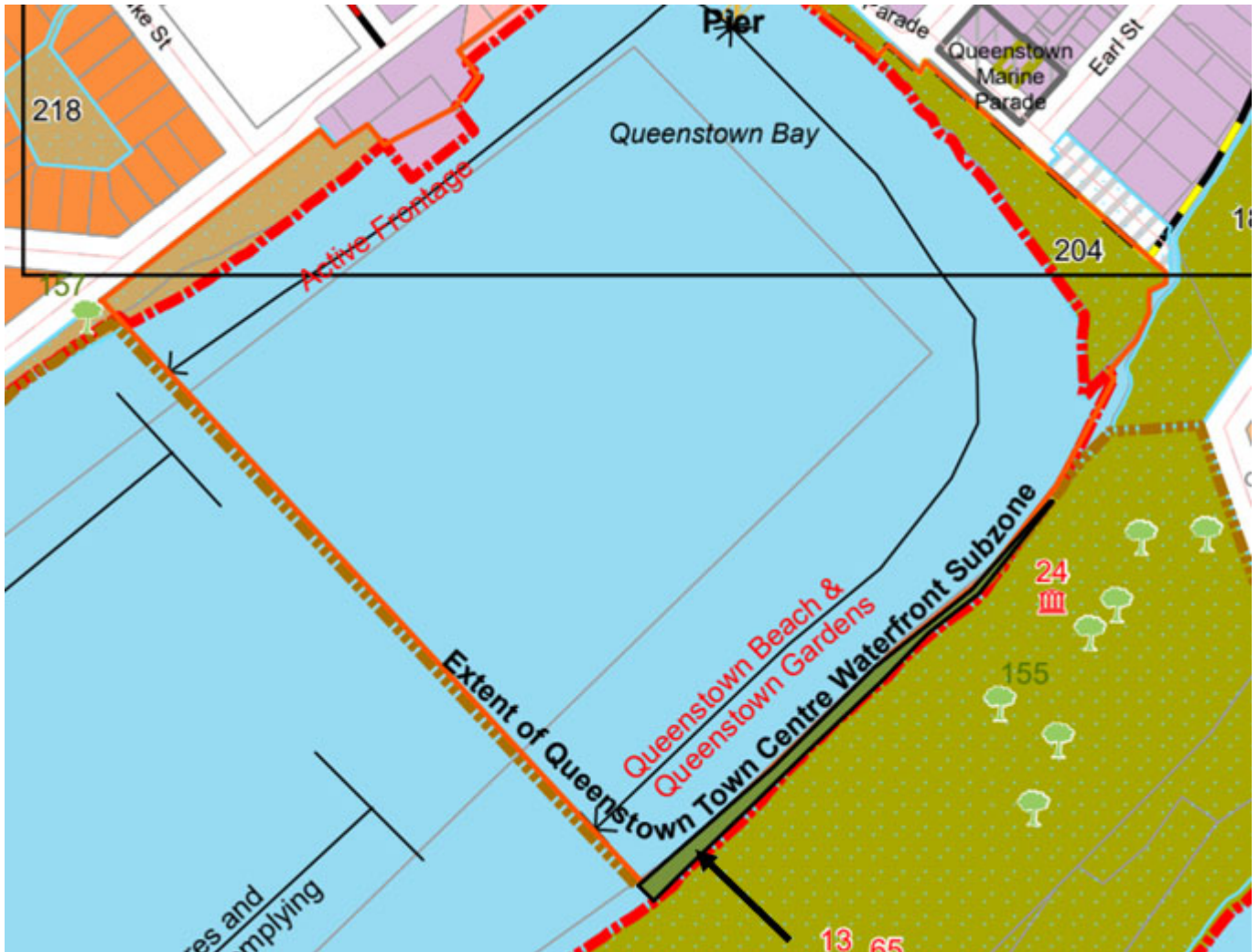

Figure 4 – Rural Zone to be deleted from the area shown as khaki green with a bold black outline and replace with CPZ, as shown (retain the ONL, UGB, and QTWSZ boundaries unchanged)