

Draft Parks Strategy

<https://fluidsurveys.com/account/surveys/1100420/responses/export//surveys/qldc/parks-strategy-notification/985a61631496a1e598231f905384aec07f83e40f/>

Filled Monday, November 28, 2016

Page 1

Your details

First Name:

Ben

Last Name:

Christophers

Email Address:

Ben.j.christopherd@gmail.com

I am submitting as a:

- Resident / Ratepayer

Where in the district do you live?

Albert Town

Page 2

Section 1 - Distribution of Open Space

The draft Strategy provides guidance on how much and the types of open space should be available in communities across the district.

Are you happy with the amount and size of parks and open space in your community?

No

Would you like to provide any further comment?

We need more recreational areas and parks. There are no open spaces within the community. We need recreational areas that are sheltered from the heavy weather that can belt this region. Something that is far and few between in central Otago.

Section 2 - Park Types

The draft Strategy sets a vision for providing a diverse, multipurpose range of parks and reserves for our residents and visitors.

Do you agree with the types of parks being described in the draft Strategy?

Yes

Are we missing anything in this area?

cycle ways and trails sheltered by forest with a gradient suitable for single track and downhill mountain biking.

Section 3 - Action Plan

The draft Strategy includes an action plan setting out short, medium, long term and ongoing projects.

Have we got our priorities and/or actions right in the proposed action plan?

No

If you answered no, please explain where priorities should change or indicate where you think Council should invest:

As above. More tracks that are sheltered with a suitable gradient for single track and downhill.

Section 4 - Final Comments

Do you have any other comments about the provision of parks and open space in the Queenstown Lakes District?

Mountain biking is a big draw card for wanaka locals and visitors. People come to wanaka for its outdoor lifestyle and easy accessability to fantastic mountainbiking trails.

Draft Parks Strategy

<https://fluidsurveys.com/account/surveys/1100420/responses/export//surveys/qldc/parks-strategy-notification/a63ec3bfb25848cc084879536300771be62d2bb5/>

Filled Wednesday, November 30, 2016

Page 1

Your details

First Name:

Bianca

Last Name:

Crichton

Email Address:

bianca.crichton@xtra.co.nz

I am submitting as a:

- Club / Organisation or School

Where in the district do you live?

Fernhill

Page 2

Section 1 - Distribution of Open Space

The draft Strategy provides guidance on how much and the types of open space should be available in communities across the district.

Are you happy with the amount and size of parks and open space in your community?

Yes

Would you like to provide any further comment?

At the moment there is a good number of parks and open spaces for people to enjoy and it is important that we preserve those spaces.

Section 2 - Park Types

The draft Strategy sets a vision for providing a diverse, multipurpose range of parks and reserves for our residents and visitors.

Do you agree with the types of parks being described in the draft Strategy?

Yes

Are we missing anything in this area?

There is no account of the Legend of the Lake in Queenstown. We should get youth to paint an illustrated story depicting the Legend of the Lake on the wall along the beach front.

{No response}

Section 3 - Action Plan

The draft Strategy includes an action plan setting out short, medium, long term and ongoing projects.

Have we got our priorities and/or actions right in the proposed action plan?

Yes

If you answered no, please explain where priorities should change or indicate where you think Council should invest:

{No response}

Section 4 - Final Comments

Do you have any other comments about the provision of parks and open space in the Queenstown Lakes District?

There is no account of the Legend of the Lake in Queenstown. We should get youth to paint an illustrated story depicting the Legend of the Lake on the wall along the beach front.

(No response)

Draft Parks Strategy

<https://fluidsurveys.com/account/surveys/1100420/responses/export//surveys/qldc/parks-strategy-notification/ed62b6af2edea9c0742d1cc87e32de6e1d683c86/>

Filled Wednesday, November 16, 2016

Page 1

Your details

First Name:

Chris

Last Name:

Buckley

Email Address:

chris@southernbars.nz

I am submitting as a:

• Resident / Ratepayer

Where in the district do you live?

Arrowtown

Page 2

Section 1 - Distribution of Open Space

The draft Strategy provides guidance on how much and the types of open space should be available in communities across the district.

Are you happy with the amount and size of parks and open space in your community?

Yes

Would you like to provide any further comment?

(No response)

Section 2 - Park Types

The draft Strategy sets a vision for providing a diverse, multipurpose range of parks and reserves for our residents and visitors.

Do you agree with the types of parks being described in the draft Strategy?

Yes

Are we missing anything in this area?

(No response)

Section 3 - Action Plan

The draft Strategy includes an action plan setting out short, medium, long term and ongoing projects.

Have we got our priorities and/or actions right in the proposed action plan?

No

If you answered no, please explain where priorities should change or indicate where you think Council should invest:

There needs to be issues addressed around NYE/Winterfest events on Earnslaw Park, the stages block out local businesses often facing away from venues on nights of the year where good profit can be made, these businesses spend a lot of money to be where they are and pay significant rates also, also these events bring other trade stall holders such as food & alcohol stalls to compete with ratepaying business on an unfair level (no rates paid, no toilets/ no safe food handling procedures, no benefit to the community and leave rubbish for the public/council to pick up) this is also obvious at the recent night noodle markets that were run at a time of year when businesses are experiencing a quieter period.

Section 4 - Final Comments

Do you have any other comments about the provision of parks and open space in the Queenstown Lakes District?

No liquor should be sold on these parks/open spaces and no food unless it is for sports teams or local charities.

Draft Parks Strategy

<https://fluidsurveys.com/account/surveys/1100420/responses/export//surveys/qldc/parks-strategy-notification/a401e623214f8238eb7196380b3b349f3aa1804c/>

Filled Friday, November 25, 2016

Page 1

Your details

First Name:

Chrissie

Last Name:

Thomson

Email Address:

Chookthomson@gmail.com

I am submitting as a:

• Resident / Ratepayer

Where in the district do you live?

Wanaka

Page 2

Section 1 - Distribution of Open Space

The draft Strategy provides guidance on how much and the types of open space should be available in communities across the district.

Are you happy with the amount and size of parks and open space in your community?

No

Would you like to provide any further comment?

In particular,I would like to raise the issue of horse riding...There are plenty of Mountain biking and walking tracks in our area,but pretty much horse riders are left to battle it out with trucks and traffic on roads.

I have just experienced again today,speeding traffic making it difficult to keep myself safe...

I'd like to have dedicated horse riding trails and and grass verge area to escape from traffic along our roads.

Section 2 - Park Types

The draft Strategy sets a vision for providing a diverse, multipurpose range of parks and reserves for our residents and visitors.

Do you agree with the types of parks being described in the draft Strategy?

Yes

Are we missing anything in this area?

I support the concept of providing safe multi purpose areas for residents and locals but feel that the horse riding section of the community do not have this availability.

As the population in our area is rapidly increasing...quiet country roads are no longer that!

(No response)

Section 3 - Action Plan

The draft Strategy includes an action plan setting out short, medium, long term and ongoing projects.

Have we got our priorities and/or actions right in the proposed action plan?

No

If you answered no, please explain where priorities should change or indicate where you think Council should invest:

Yes and No!!!

Of course it is important to maintain green areas ,trails,foreshores etc...but what about the horse riders?

We also want to be safe.

(No response)

Section 4 - Final Comments

Do you have any other comments about the provision of parks and open space in the Queenstown Lakes District?

The provision of parks and open space in the Queenstown Lakes District is a valuable part of not only our heritage and history,but also needs to be available for future generations.

Horses have been a huge part of our history..."Horses made NZ" my grandfather used to say....

As land becomes occupied by more high(and low) density housing, and traffic increases both in speed,volume and tonnage on our roads-there is a need to protect and keep safe the horse riding section of the Community...rather than to exclude us!

Draft Parks Strategy

<https://fluidsurveys.com/account/surveys/1100420/responses/export//surveys/qldc/parks-strategy-notification/f5b72464d0e6b2c1b9c70b5226cc17dd55441b79/>

Filled Thursday, November 24, 2016

Page 1

Your details

First Name:

(Dr.) David

Last Name:

Gray

Email Address:

mdgray@xtra.co.nz

I am submitting as a:

• Developer

Where in the district do you live?

Wanaka

Page 2

Section 1 - Distribution of Open Space

The draft Strategy provides guidance on how much and the types of open space should be available in communities across the district.

Are you happy with the amount and size of parks and open space in your community?

Yes

Would you like to provide any further comment?

(No response)

Section 2 - Park Types

The draft Strategy sets a vision for providing a diverse, multipurpose range of parks and reserves for our residents and visitors.

Do you agree with the types of parks being described in the draft Strategy?

No

Are we missing anything in this area?

YES. On page 20 of the brochure under 'Types of Parks / Experiences' Pembroke Park is described as a 'Sportsground Park'. IT IS NOT A SPORTSGROUND PARK. PEMBROKE SHOULD BE UNDER ' COMMUNITY PARK ' CATEGORY AND DELETED FROM SPORTSGROUND PARK LIST.

This is a serious error by the QLDC in my view, and has serious implications if this isn't clarified.

Section 3 - Action Plan

The draft Strategy includes an action plan setting out short, medium, long term and ongoing projects.

Have we got our priorities and/or actions right in the proposed action plan?

No

If you answered no, please explain where priorities should change or indicate where you think Council should invest:

See above section

Section 4 - Final Comments

Do you have any other comments about the provision of parks and open space in the Queenstown Lakes District?

As above i want to see the designation of Pembroke Park corrected.

I am also concerned that had I not been speaking with a friend I would not have known that a submission could be made, and have only seen a date for same on man email to my friend. I wonder how widely this has been publicised

Draft Parks Strategy

<https://fluidsurveys.com/account/surveys/1100420/responses/export//surveys/qldc/parks-strategy-notification/310be31ee948f8609387bebc1ca1d1abc5fb2fa8/>

Filled Friday, December 16, 2016

Page 1

Your details

First Name:

David

Last Name:

Whiteside

Email Address:

mahana.downs@xtra.co.nz

I am submitting as a:

- Resident / Ratepayer

Where in the district do you live?

{No response}

Page 2

Section 1 - Distribution of Open Space

The draft Strategy provides guidance on how much and the types of open space should be available in communities across the district.

Are you happy with the amount and size of parks and open space in your community?

Yes

Would you like to provide any further comment?

On page 20, Pembroke Park is listed as an example of a "Sportsground Park"

On page 26, the chart shows a "Sportsground Park" as having Changing Rooms.

Please refer to the Pembroke Park Reserve Management Plan 2007, Policy 14.1: "Erection of new buildings.....shall not be permitted....

Under this Policy, the building of Changing Rooms is not a permitted activity, and therefore, Pembroke Park IS NOT, AND CAN NOT BE a "Sportsground" park.

Section 2 - Park Types

The draft Strategy sets a vision for providing a diverse, multipurpose range of parks and reserves for our residents and visitors.

Do you agree with the types of parks being described in the draft Strategy?

(No response)

Are we missing anything in this area?

(No response)

Section 3 - Action Plan

The draft Strategy includes an action plan setting out short, medium, long term and ongoing projects.

Have we got our priorities and/or actions right in the proposed action plan?

(No response)

If you answered no, please explain where priorities should change or indicate where you think Council should invest:

(No response)

Section 4 - Final Comments

Do you have any other comments about the provision of parks and open space in the Queenstown Lakes District?

(No response)

Draft Parks Strategy

<https://fluidsurveys.com/account/surveys/1100420/responses/export//surveys/qldc/parks-strategy-notification/9dbd355d17c1a7262747514d35437ab2e4226985/>

Filled Wednesday, December 14, 2016

Page 1

Your details

First Name:

Diana

Last Name:

Power

Email Address:

diana@cansoc.org.nz

I am submitting as a:

- Club / Organisation or School

Where in the district do you live?

I live outside the Queenstown Lakes District

Page 2

Section 1 - Distribution of Open Space

The draft Strategy provides guidance on how much and the types of open space should be available in communities across the district.

Are you happy with the amount and size of parks and open space in your community?

Yes

Would you like to provide any further comment?

(No response)

Section 2 - Park Types

The draft Strategy sets a vision for providing a diverse, multipurpose range of parks and reserves for our residents and visitors.

Do you agree with the types of parks being described in the draft Strategy?

Yes

Are we missing anything in this area?

(No response)

Section 3 - Action Plan

The draft Strategy includes an action plan setting out short, medium, long term and ongoing projects.

Have we got our priorities and/or actions right in the proposed action plan?

No

If you answered no, please explain where priorities should change or indicate where you think Council should invest:

The Central Otago and Wakatipu Smokefree Coalition concur that the priorities for open spaces are right. However in order for 'quality' spaces that 'protect ecosystems that are essential to a healthy environment' council should be also considering the development of a Smokefree parks and open space strategy. This will progress work begun by QLDC in 2006 around Smokefree playgrounds.

The Action plan could contain development of a Smokefree strategy for all QLDC Parks and open spaces thus protecting outstanding landscapes and allowing 'open spaces that promote health and wellbeing' for our local community and visitors. Young people are less likely to begin smoking if they are not witnessing others smoking. The natural ambience of our open spaces is enhanced by

not sighting cigarette butts or being exposed to second hand smoke. The absence of second hand smoke contributes to our health and wellbeing.

The Smokefree Policy would be non-regulatory. The Council is not banning smoking nor can people be fined for it. Instead the policy encourages people to refrain from smoking in these areas and focuses on education and awareness through signage.

(No response)

Section 4 - Final Comments

Do you have any other comments about the provision of parks and open space in the Queenstown Lakes District?

Adoption and communication of a comprehensive and clearly visible Smokefree policy is a formalised and positive statement that the QLDC cares about the wellbeing of both visitors and members of their community while enhancing the natural beauty of our parks and open spaces where people 'live, work and play'.

Draft Parks Strategy

<https://fluidsurveys.com/account/surveys/1100420/responses/export//surveys/qldc/parks-strategy-notification/a32cca91fd02188c7440c20988d8f18ee2687373/>

Filled Tuesday, December 13, 2016

Page 1

Your details

First Name:

Elisabeth

Last Name:

Ford

Email Address:

lis_1962@hotmail.com

I am submitting as a:

- Resident / Ratepayer

Where in the district do you live?

Jacks Point

Page 2

Section 1 - Distribution of Open Space

The draft Strategy provides guidance on how much and the types of open space should be available in communities across the district.

Are you happy with the amount and size of parks and open space in your community?

No

Would you like to provide any further comment?

I am happy with the amount and quality of the Parks and open space that can be used by individuals, families and sporting groups, however there is no open space that could be safely used by the horse riding community, particularly for the younger riders in the community. The local Pony Club and Riding Club currently have the use of private land, however that could cease at any given time as the land could be sold and the new owners may not be conducive to horse riders making use of the land.

Section 2 - Park Types

The draft Strategy sets a vision for providing a diverse, multipurpose range of parks and reserves for our residents and visitors.

Do you agree with the types of parks being described in the draft Strategy?

No

Are we missing anything in this area?

Whilst Queenstown has a superb number of parks and reserves (one of the reasons we love living here). As mentioned previously we would love to have a dedicated area (approx. 5 acres) where horse owners could take their horses to train and hold small, local competitions would be wonderful.

Section 3 - Action Plan

The draft Strategy includes an action plan setting out short, medium, long term and ongoing projects.

Have we got our priorities and/or actions right in the proposed action plan?

No

If you answered no, please explain where priorities should change or indicate where you think Council should invest:

It would be wonderful to see the provision for more (off road) horse riding trails, specifically some shared trails with pedestrians and bicycles using the existing cycle trail network. There are many

examples around NZ of shared trails, most notably the Central Otago Rail Trail. The current NZ Cycleways network here in the basin has places where horse riding could be conducted safely along with the walkers and cyclists. Basically, any trail that is wide enough (3 metres) and straight enough to provide good visibility and clearance for users to pass, could be used for all three activities.

Section 4 - Final Comments

Do you have any other comments about the provision of parks and open space in the Queenstown Lakes District?

The creation of new horse riding trails in the district would be very well received by the horse riding community. There are large tracks of land currently under management by QLDC that might accomodate horse riding using existing 4WD tracks. The Coronet Forestry is an area that is currently used, it would be great if once the trees have been cut and cleared in the forestry to develop a larger network of trails on the hill, specifically for horse riding. Currently, this is the ONLY place in the entire Wakatipu where horses can be safely ridden without motorists....we could really use additional trails that are off road. Another option is to explore the possibility of using existing 4WD tracks in the Soho Properties land. Thank you for the chance to provide input.

Draft Parks Strategy

<https://fluidsurveys.com/account/surveys/1100420/responses/export//surveys/qldc/parks-strategy-notification/0f70f4f52aa8816e7a7d269ba8a443eb2298e7a5/>

Filled Sunday, December 18, 2016

Page 1

Your details

First Name:

emma

Last Name:

vickers

Email Address:

emma_vickers@me.com

I am submitting as a:

- Resident / Ratepayer

Where in the district do you live?

Wanaka

Page 2

Section 1 - Distribution of Open Space

The draft Strategy provides guidance on how much and the types of open space should be available in communities across the district.

Are you happy with the amount and size of parks and open space in your community?

Yes

Would you like to provide any further comment?

Pembroke Park- community park or sports ground park? The skate park is great but the remainder of the park has very little to offer the community. It is several acres and whilst provides space for ball games and kite surf practice, it offers no shade, walks, landscaping, cultural/visual appeal etc. I believe Wanaka would really benefit from a portion of the park the have beautiful planting and landscaping as in Queenstown or even lower Bullock Creek in Wanaka. A much underused asset!!

Section 2 - Park Types

The draft Strategy sets a vision for providing a diverse, multipurpose range of parks and reserves for our residents and visitors.

Do you agree with the types of parks being described in the draft Strategy?

Yes

Are we missing anything in this area?

Botanical Gardens at Pembroke Park

Section 3 - Action Plan

The draft Strategy includes an action plan setting out short, medium, long term and ongoing projects.

Have we got our priorities and/or actions right in the proposed action plan?

Yes

If you answered no, please explain where priorities should change or indicate where you think Council should invest:

(No response)

Section 4 - Final Comments

Do you have any other comments about the provision of parks and open space in the Queenstown Lakes District?

Well as everyone I know says, the carpark at Lake Wanaka waterfront needs to GO!! It's not safe for pedestrians and it destroys the views.

Draft Parks Strategy

<https://fluidsurveys.com/account/surveys/1100420/responses/export//surveys/qldc/parks-strategy-notification/b689b657501442d9f4d32d47c5a863f5238965fc/>

Filled Monday, November 28, 2016

Page 1

Your details

First Name:

Ewan

Last Name:

Mackie

Email Address:

ewanjmackie@gmail.com

I am submitting as a:

- Resident / Ratepayer

Where in the district do you live?

Wanaka

Page 2

Section 1 - Distribution of Open Space

The draft Strategy provides guidance on how much and the types of open space should be available in communities across the district.

Are you happy with the amount and size of parks and open space in your community?

Yes

Would you like to provide any further comment?

We need to ensure that this open space is protected and access is improved for all different types of recreation. Areas such as Sticky Forrest, Hikuwai and the wider lakefront need to be protected from devleopment. They should all become public land, where possible.

Section 2 - Park Types

The draft Strategy sets a vision for providing a diverse, multipurpose range of parks and reserves for our residents and visitors.

Do you agree with the types of parks being described in the draft Strategy?

Yes

Are we missing anything in this area?

(No response)

Section 3 - Action Plan

The draft Strategy includes an action plan setting out short, medium, long term and ongoing projects.

Have we got our priorities and/or actions right in the proposed action plan?

Yes

If you answered no, please explain where priorities should change or indicate where you think Council should invest:

(No response)

Section 4 - Final Comments

Do you have any other comments about the provision of parks and open space in the Queenstown Lakes District?

(No response)

Draft Parks Strategy

<https://fluidsurveys.com/account/surveys/1100420/responses/export//surveys/qldc/parks-strategy-notification/c13212853cb279f0150f9bdb85307b70237bc8cf/>

Filled Monday, November 21, 2016

Page 1

Your details

First Name:

Gibbston Community Association

Last Name:

GCA

Email Address:

gibbstoncommunity@gmail.com

I am submitting as a:

- Other

Where in the district do you live?

Gibbston

Page 2

Section 1 - Distribution of Open Space

The draft Strategy provides guidance on how much and the types of open space should be available in communities across the district.

Are you happy with the amount and size of parks and open space in your community?

Yes

Would you like to provide any further comment?

We would like better maintenance and care of what we have. This includes our reserve at Coal Pit Road and the cycle trails through Gibbston

Section 2 - Park Types

The draft Strategy sets a vision for providing a diverse, multipurpose range of parks and reserves for our residents and visitors.

Do you agree with the types of parks being described in the draft Strategy?

Yes

Are we missing anything in this area?

(No response)

Section 3 - Action Plan

The draft Strategy includes an action plan setting out short, medium, long term and ongoing projects.

Have we got our priorities and/or actions right in the proposed action plan?

No

If you answered no, please explain where priorities should change or indicate where you think Council should invest:

What you are proposing for urban areas seems reasonable - subject to cost (ongoing maintenance). We're not sure this best serves rural areas such as Gibbston. We request further information on your plans for Gibbston.

Section 4 - Final Comments

Do you have any other comments about the provision of parks and open space in the Queenstown Lakes District?

(No response)

Draft Parks Strategy

<https://fluidsurveys.com/account/surveys/1100420/responses/export//surveys/qldc/parks-strategy-notification/38ea4570d28ed07bdf9156f16d6fea7c0fa2178/>

Filled Monday, December 05, 2016

Page 1

Your details

First Name:

HILARY

Last Name:

ROBINSON

Email Address:

HILARY777@ME.COM

I am submitting as a:

- Resident / Ratepayer

Where in the district do you live?

Wanaka

Page 2

Section 1 - Distribution of Open Space

The draft Strategy provides guidance on how much and the types of open space should be available in communities across the district.

Are you happy with the amount and size of parks and open space in your community?

Yes

Would you like to provide any further comment?

Bridleways which are safe for horses, as they have in the UK, are urgently required. In the UK cyclists and walkers can also use bridleways -- they are found in every town and village and throughout the country and marked on all the OS maps.. In New Zealand horses are not even recognised in the Highway Code. Horse riders require safe places to ride so that they do not have to cross busy roads. Forming bridleways as the government has done for cyclists in NZ would be another boost for tourism in addition to all the horse riders who live in NZ and have nowhere safe to ride.

Section 2 - Park Types

The draft Strategy sets a vision for providing a diverse, multipurpose range of parks and reserves for our residents and visitors.

Do you agree with the types of parks being described in the draft Strategy?

Yes

Are we missing anything in this area?

Bridleways for horses:

Bridleways which are safe for horses, such as they have in the UK, are urgently required. In the UK cyclists and walkers can also use bridleways -- they are found in every town and village and throughout the country and marked on all the OS maps.. In New Zealand horses are not even recognised in the Highway Code. Horse riders require safe places to ride so that they do not have to cross busy roads. Forming bridleways as the government has done for cyclists in NZ would be another boost for tourism in addition to all the horse riders who live in NZ and have nowhere safe to ride.

Section 3 - Action Plan

The draft Strategy includes an action plan setting out short, medium, long term and ongoing projects.

Have we got our priorities and/or actions right in the proposed action plan?

No

If you answered no, please explain where priorities should change or indicate where you think Council should invest:

As a horse rider bridleways are required to form SAFE connecting rides throughout the area away from traffic.

Section 4 - Final Comments

Do you have any other comments about the provision of parks and open space in the Queenstown Lakes District?

{No response}

Draft Parks Strategy

<https://fluidsurveys.com/account/surveys/1100420/responses/export//surveys/qldc/parks-strategy-notification/38ea4570d28ed07bdf9156f16d6fea7c0fa2178/>

Filled Monday, December 05, 2016

Page 1

Your details

First Name:

HILARY

Last Name:

ROBINSON

Email Address:

HILARY777@ME.COM

I am submitting as a:

• Resident / Ratepayer

Where in the district do you live?

Wanaka

Page 2

Section 1 - Distribution of Open Space

The draft Strategy provides guidance on how much and the types of open space should be available in communities across the district.

Are you happy with the amount and size of parks and open space in your community?

Yes

Would you like to provide any further comment?

Bridleways which are safe for horses, as they have in the UK, are urgently required. In the UK cyclists and walkers can also use bridleways -- they are found in every town and village and throughout the country and marked on all the OS maps.. In New Zealand horses are not even recognised in the Highway Code. Horse riders require safe places to ride so that they do not have to cross busy roads. Forming bridleways as the government has done for cyclists in NZ would be another boost for tourism in addition to all the horse riders who live in NZ and have nowhere safe to ride.

Section 2 - Park Types

The draft Strategy sets a vision for providing a diverse, multipurpose range of parks and reserves for our residents and visitors.

Do you agree with the types of parks being described in the draft Strategy?

Yes

Are we missing anything in this area?

Bridleways for horses:

Bridleways which are safe for horses, such as they have in the UK, are urgently required. In the UK cyclists and walkers can also use bridleways -- they are found in every town and village and throughout the country and marked on all the OS maps.. In New Zealand horses are not even recognised in the Highway Code. Horse riders require safe places to ride so that they do not have to cross busy roads. Forming bridleways as the government has done for cyclists in NZ would be another boost for tourism in addition to all the horse riders who live in NZ and have nowhere safe to ride.

Section 3 - Action Plan

The draft Strategy includes an action plan setting out short, medium, long term and ongoing projects.

Have we got our priorities and/or actions right in the proposed action plan?

No

If you answered no, please explain where priorities should change or indicate where you think Council should invest:

As a horse rider bridleways are required to form SAFE connecting rides throughout the area away from traffic.

Section 4 - Final Comments

Do you have any other comments about the provision of parks and open space in the Queenstown Lakes District?

(No response)

Draft Parks Strategy

<https://fluidsurveys.com/account/surveys/1100420/responses/export//surveys/qldc/parks-strategy-notification/1910227af5583f2c06671ae89b45beee3681dc4c/>

Filled Wednesday, December 14, 2016

Page 1

Your details

First Name:

Iris

Last Name:

Abaecherli

Email Address:

gaziris@xtra.co.nz

I am submitting as a:

- Resident / Ratepayer

Where in the district do you live?

Wanaka

Page 2

Section 1 - Distribution of Open Space

The draft Strategy provides guidance on how much and the types of open space should be available in communities across the district.

Are you happy with the amount and size of parks and open space in your community?

Yes

Would you like to provide any further comment?

I said yes, but I want to say this: the amount of people living here is going to grow. Some are happy with swimming pools and sports facilities like we have a new one now in Wanaka; of course we have to pay for this, every single ratepayer. Even if we do not use these facilities.

This attempt at a submission is ... I would like to see Sticky Forest, my personal play ground since moving to Wanaka in 2000, included in what you call parks and open space in my community for recreational use - free of charge, haha.

Section 2 - Park Types

The draft Strategy sets a vision for providing a diverse, multipurpose range of parks and reserves for our residents and visitors.

Do you agree with the types of parks being described in the draft Strategy?

Yes

Are we missing anything in this area?

I'm sure you don't miss anything, it's just me!

saying yes again without really being sure. Like many of your questions, you are fishing for positive stuff. Sure I agree to everything and anything except: stop using poison such as 1080 and diquat in our recreational areas - better yet: anywhere! and yes the water is recreational as well. There are torgon, cyanide and pindone too, everywhere. May be in your future planning can you consider that there is a part of the population who would like to exercise outside in our beautiful nature, without all the poisons being present all the time.

Section 3 - Action Plan

The draft Strategy includes an action plan setting out short, medium, long term and ongoing projects.

Have we got our priorities and/or actions right in the proposed action plan?

Yes

If you answered no, please explain where priorities should change or indicate where you think Council should invest:

OK, yes you do it all just fine. Just in case though, can you please consider that some of us don't need the expensive indoor facilities but are quite happy to walk and bike in places like Sticky Forest - can this be added to our recreational reserves?

(No response)

Section 4 - Final Comments

Do you have any other comments about the provision of parks and open space in the Queenstown Lakes District?

No, just my apologies with having trouble to submit a proper submission. I've written this following your invitation in the last Clutha messenger "last days to have your say" and with regards to Easter trading, it's been too long and too wishy washy, how come some Marty Black can invent a new law on our lakes just within a few minutes* and Easter trading is still not possible, my message is get on with it and allow everybody to trade.

*talking about the control freak behaviour of imposing life jackets on paddle boards, changing rules all the time, from one year to the next and not accepting that people should simple be responsible for their actions.

Draft Parks Strategy

<https://fluidsurveys.com/account/surveys/1100420/responses/export//surveys/qldc/parks-strategy-notification/b2fe4928c8838242787038f17d5432f2734312e5/>

Filled Monday, December 05, 2016

Page 1

Your details

First Name:

jan

Last Name:

Grant

Email Address:

janfeath@xtra.co.nz

I am submitting as a:

- Resident / Ratepayer

Where in the district do you live?

Wanaka

Page 2

Section 1 - Distribution of Open Space

The draft Strategy provides guidance on how much and the types of open space should be available in communities across the district.

Are you happy with the amount and size of parks and open space in your community?

Yes

Would you like to provide any further comment?

(No response)

Section 2 - Park Types

The draft Strategy sets a vision for providing a diverse, multipurpose range of parks and reserves for our residents and visitors.

Do you agree with the types of parks being described in the draft Strategy?

No

Are we missing anything in this area?

Yes I think there should be bridle ways for horses in the local area. There are many people who ride and there is limited areas to do this

Section 3 - Action Plan

The draft Strategy includes an action plan setting out short, medium, long term and ongoing projects.

Have we got our priorities and/or actions right in the proposed action plan?

No

If you answered no, please explain where priorities should change or indicate where you think Council should invest:

More bridle ways for horses to ride and enjoy the natural areas.

Section 4 - Final Comments

Do you have any other comments about the provision of parks and open space in the Queenstown Lakes District?

(No response)

Draft Parks Strategy

<https://fluidsurveys.com/account/surveys/1100420/responses/export//surveys/qldc/parks-strategy-notification/655c0feb99926a31c7f83417da7e2e199c48db56/>

Filled Thursday, December 15, 2016

Page 1

Your details

First Name:

Jo

Last Name:

O'Connor

Email Address:

Jo.oconnor@wellsouth.org.nz

I am submitting as a:

• Other

Where in the district do you live?

I live outside the Queenstown Lakes District

Page 2

Section 1 - Distribution of Open Space

The draft Strategy provides guidance on how much and the types of open space should be available in communities across the district.

Are you happy with the amount and size of parks and open space in your community?

No

Would you like to provide any further comment?

WellSouth commends council on development of this strategy which acknowledges the importance of a planned approach to develop and maintain quality open space networks for a safe and healthy community now and in the future.

Section 2 - Park Types

The draft Strategy sets a vision for providing a diverse, multipurpose range of parks and reserves for our residents and visitors.

Do you agree with the types of parks being described in the draft Strategy?

Yes

Are we missing anything in this area?

(No response)

No. Prioritising different types of parks and open spaces acknowledges the wide range of parks and open spaces in the district and different levels of service required.

(No response)

Section 3 - Action Plan

The draft Strategy includes an action plan setting out short, medium, long term and ongoing projects.

Have we got our priorities and/or actions right in the proposed action plan?

No

If you answered no, please explain where priorities should change or indicate where you think Council should invest:

The range of types and minimum expectations of facilities for each park type generally reflects consideration for the health and wellbeing of residents and visitors. Actions to improve resident satisfaction levels, from previous consultation, around facilities needed at parks are addressed. To further enhance resident satisfaction and health and wellbeing WellSouth recommends drinking

fountains are available at all community parks. Water fountains serve the dual purpose of encouraging children, young people and adults to drink water and reduce plastic bottle usage.

WellSouth encourages initiatives to make communities Smokefree. QLDC has previously agreed that their playgrounds and swimming pools are Smokefree. It is now opportune for QLDC to develop an overall Smokefree Parks and Open Spaces strategy in line with many other local authorities which will guide all subsequent individual park plans. Smokefree environments are congruent to council goals of quality natural environments and national goals for a Smokefree 2025.

(No response)

Section 4 - Final Comments

Do you have any other comments about the provision of parks and open space in the Queenstown Lakes District?

WellSouth commends council on planning for multifunctional open spaces to meet the growing and diverse needs of communities and visitors.

Health in all its forms – page 9 acknowledges physical health (Taha Tinana) and psychological health (Taha Hinengaro). Including the Whare Tapa Wha model of health here would be appropriate as parks and open spaces also influence family health and spiritual health (Taha Whanau and Taha Wairua). The connection with nature and culture is mentioned in the strategy but there is no specific mention of the cultural significance to Maori.

WellSouth recommends extension of the Alcohol Ban Bylaw 2014 to include parks and open spaces. The effectiveness of the liquor ban would increase with the development and implementation of a comprehensive approach to alcohol harm reduction. Development of a comprehensive alcohol policy pertaining to parks and open spaces or inclusion of parks and open spaces in a future local alcohol policy would signal council commitment to reducing alcohol related harm in the district. Such a policy could contribute to reducing negative media publicity as occurred with Crate Day.

Throughout the world policies that limit where drinking can occur are common. In North America drinking is prohibited in most public places other than licensed premises. In Western Europe, as far back as 2001 it was estimated 60% of countries ban alcohol consumption in public places. Almost half ban drinking at sporting events. Partial or complete liquor bans are also prevalent in major Australian cities (Hazebrook and Hasley 2000).

This submission was developed by the Health Promotion Team at WellSouth Primary Health Network (WellSouth).

WellSouth is a charitable trust funded by the Southern District Health Board to provide primary health care services to residents enrolled with general practices in Otago and Southland. These services include first contact support to restore people's health when they are unwell as well as range of programmes to improve access to health care services to promote and maintain good

health. The health promotion programme facilitates the process of enabling people to increase control over, and to improve, their health. One aspect of health promotion is to advocate for healthy social, cultural and physical environments.

(No response)

Jeannie Galavazi

From: John Darby <john.darby@xtra.co.nz>
Sent: Friday, 25 November 2016 5:12 PM
To: Jeannie Galavazi
Subject: RE: Draft QLDC Parks and Open Spaces Strategy

Hi Jeannie,

I wonder if you can tell me what is happening on the land above the Marina. I am discouraged to note that the area is now littered with survey pegs marked road boundary. There is no doubt whatsoever that if a proposal to change road boundary's occurs in this area, then many, if not all the willows among other things will disappear. I would be pleased to know quite what is the intention of the changes to the road. Is it to create more roadside parking? If so I would plead that QLDC look closely at where it is taking this problem to. I have some information that suggests that willows will also be taken down in the carpark between the Yacht Club and the marina, again, primarily to provide more parking facilities. That actually will only be achieved by filling in the lake-is that the direction that QLDC is taking. Is it possible to receive an assurance that fill will not be placed into the lake to provide additional parking? I would be keen to receive some answers to these questions

Many thanks.

John

John Darby
52 Meadowstone Drive,
Wanaka
9305
03 4432413
0212569576

From: Jeannie Galavazi [<mailto:Jeannie.Galavazi@qldc.govt.nz>]
Sent: Thursday, November 17, 2016 2:27 PM
To: Jeannie Galavazi
Subject: Draft QLDC Parks and Open Spaces Strategy

Hello

QLDC is reviewing its Parks and Open Spaces Strategy. We want to ensure that our existing open space and new reserves are meeting the needs of the community and are protected for future generations.

The draft strategy can be found here: <http://www.qldc.govt.nz/your-council/your-views/parks-strategy-feedback/>. We invite you to read the strategy and make a submission on any part of it that interests you (you've been emailed this as you are listed as being the contact for a community group, sports club or organisation).

The previous QLDC Parks Strategy was developed in 2002 – at the time it was intended to be a 10 year strategy. Since then, the District has grown a lot – both in residential and visitor numbers. New subdivisions are being created, and intensification of some of the existing urban area is planned.

The strategy sets direction on:

- > The types of open spaces and experiences that the community should be able to access
- > How much open space is expected be provided in greenfield developments
- > Future development and use of existing open space
- > Spending of Development Contributions
- > Ecological and biodiversity protection and enhancement

The Strategy also contains an action plan setting out what will happen once the Strategy is adopted. For example in the Strategy it says everyone in a residential area should be within 600m (5-10 minutes easy walk) from a local or community park. It also says that individual open space network plans will be created for each area which will analyse what's currently available versus the community needs.

If you'd like to make a submission on the draft Strategy, you'll find an online submission form here: <http://fluidsurveys.com/surveys/qldc/parks-strategy-notification/>

Submissions close on Friday 16 December.

If you'd like to discuss any aspect of the draft Parks and Open Space strategy, you can contact me direct. We are also considering holding two focus groups (one in Queenstown, one in Wanaka) where staff will be present to answer questions and facilitate a round table discussion with other community groups. If you would be interested in attending this please let me know via email.

Kind regards

Jeannie Galavazi | Senior Parks and Reserves Planner
Property and Infrastructure
Queenstown Lakes District Council
DD: +64 3 450 1757 | P: +64 3 441 0499
E: Jeannie.galavazi@qldc.govt.nz



Please note I work part time - Mondays, Tuesdays and Thursdays

Draft Parks Strategy

<https://fluidsurveys.com/account/surveys/1100420/responses/export//surveys/qldc/parks-strategy-notification/b60ee5f8ebf59442a35aa446d89a7ff8bba20ddf/>

Filled Sunday, December 11, 2016

Page 1

Your details

First Name:

karen

Last Name:

birkby

Email Address:

birkby@me.com

I am submitting as a:

- Club / Organisation or School

Where in the district do you live?

Wanaka

Page 2

Section 1 - Distribution of Open Space

The draft Strategy provides guidance on how much and the types of open space should be available in communities across the district.

Are you happy with the amount and size of parks and open space in your community?

No

Would you like to provide any further comment?

The existing parks in Wanaka and Albert Town cater well for the community, however with many more residential areas being developed there is an encroachment on open space. Soon Wanaka will have no open space to enjoy as the land or nearby land will have been built on.

Section 2 - Park Types

The draft Strategy sets a vision for providing a diverse, multipurpose range of parks and reserves for our residents and visitors.

Do you agree with the types of parks being described in the draft Strategy?

Yes

Are we missing anything in this area?

Multi purpose range of parks could become very prescribed, we need to keep areas of natural beauty as open space to protect the land and activities on that land.

Section 3 - Action Plan

The draft Strategy includes an action plan setting out short, medium, long term and ongoing projects.

Have we got our priorities and/or actions right in the proposed action plan?

No

If you answered no, please explain where priorities should change or indicate where you think Council should invest:

The council appear to have a very blinkered and short sighted plan for Wanaka and the surrounding areas. Small parks and open spaces are not going to keep residents here or encourage visitors to the area.

Section 4 - Final Comments

Do you have any other comments about the provision of parks and open space in the Queenstown Lakes District?

QLDC need to be careful not to remove or allow open spaces to be developed.

Draft Parks Strategy

<https://fluidsurveys.com/account/surveys/1100420/responses/export//surveys/qldc/parks-strategy-notification/11024dbdb20166d82305c861f9d7be5ad1dcf2c3/>

Filled Monday, November 28, 2016

Page 1

Your details

First Name:

karen

Last Name:

birkby

Email Address:

birkby@me.com

I am submitting as a:

- Resident / Ratepayer

Where in the district do you live?

Wanaka

Page 2

Section 1 - Distribution of Open Space

The draft Strategy provides guidance on how much and the types of open space should be available in communities across the district.

Are you happy with the amount and size of parks and open space in your community?

No

Would you like to provide any further comment?

There open space in the Wanaka area is quickly being taken over by large developments, many have no or very little open usable space that is of use to the community. Areas for outdoor activity are not available to the residents of Wanaka and the surrounding area. The constant talk of removing part of Penbroke Park for parking, the council changing zoning to help developers i.e. Sticky Forest.

Section 2 - Park Types

The draft Strategy sets a vision for providing a diverse, multipurpose range of parks and reserves for our residents and visitors.

Do you agree with the types of parks being described in the draft Strategy?

Yes

Are we missing anything in this area?

Open space that can be used by the community and beyond. If we continue to remove these areas there will be no reason to visit the area. Having parks and reserves are great but the community requires more than just these spaces. At the moment there is no evidence that QLDC have any effective and efficient infrastructure to meet any growth including open space. In the proposed plan it is stated that open spaces are treasured and protected, this does not appear to be the case in Wanaka as the zoning of open spaces appear to be able to be changed including those of outstanding natural beauty and sold off to developers.

Section 3 - Action Plan

The draft Strategy includes an action plan setting out short, medium, long term and ongoing projects.

Have we got our priorities and/or actions right in the proposed action plan?

No

If you answered no, please explain where priorities should change or indicate where you think Council should invest:

Retaining the zoning of open space as just that, to be treasured and protected not be sold off as so much of the land has.

Section 4 - Final Comments

Do you have any other comments about the provision of parks and open space in the Queenstown Lakes District?

Wanaka is rapidly losing all it's open space to developers, creating a small park does not make amends for the amount of open usable space that has already been taken from the community

Draft Parks Strategy

<https://fluidsurveys.com/account/surveys/1100420/responses/export//surveys/qldc/parks-strategy-notification/200b85e7fd0b8afd5658c2eb473832f7b97dd728/>

Filled Saturday, November 26, 2016

Page 1

Your details

First Name:

Lisa

Last Name:

Tsai

Email Address:

lisamtsai@yahoo.com

I am submitting as a:

- Resident / Ratepayer

Where in the district do you live?

Albert Town

Page 2

Section 1 - Distribution of Open Space

The draft Strategy provides guidance on how much and the types of open space should be available in communities across the district.

Are you happy with the amount and size of parks and open space in your community?

No

Would you like to provide any further comment?

I feel like there are lots of subdivisions going on and we are slowly losing our open spaces and I am very concerned about the current status of "Sticky Forest"

Section 2 - Park Types

The draft Strategy sets a vision for providing a diverse, multipurpose range of parks and reserves for our residents and visitors.

Do you agree with the types of parks being described in the draft Strategy?

Yes

Are we missing anything in this area?

While there are mentions of cycleways and trails, I feel like the types of cycleways and trails mentioned are more flat, minimal gradient shared walkway/cycleway especially within Wanaka. I feel like this draft Strategy is currently missing recreational singletrack for mountain biking in Wanaka itself. I think this is particularly important as many other City Councils (eg Christchurch City Council) are seeing the importance of mountain biking and the economic effect it can have to a region.

Section 3 - Action Plan

The draft Strategy includes an action plan setting out short, medium, long term and ongoing projects.

Have we got our priorities and/or actions right in the proposed action plan?

No

If you answered no, please explain where priorities should change or indicate where you think Council should invest:

I feel like more proposed single track for mountain biking in Wanaka needs to be invested by the Council. Currently the ONLY network of trails is a non-council owned/managed area of land in Sticky Forest and from what I understand, this area is currently privately owned. More money and

investment should be put into single tracks and into mountain biking as this is a sport which is quickly developing.

Section 4 - Final Comments

Do you have any other comments about the provision of parks and open space in the Queenstown Lakes District?

I would like to see more a larger network of trails being developed within Wanaka and the immediate area (Wanaka/Albert Town/Luggate/Hawea)

Draft Parks Strategy

<https://fluidsurveys.com/account/surveys/1100420/responses/export//surveys/qldc/parks-strategy-notification/c1940a5f1c7539e323ddb16089dc1b3adcdbfc5f/>

Filled Friday, December 16, 2016

Page 1

Your details

First Name:

Lorraine

Last Name:

Guthrie

Email Address:

executive@barrierfreenz.org.nz

I am submitting as a:

• Other

Where in the district do you live?

I live outside the Queenstown Lakes District

Page 2

Section 1 - Distribution of Open Space

The draft Strategy provides guidance on how much and the types of open space should be available in communities across the district.

Are you happy with the amount and size of parks and open space in your community?

(No response)

Would you like to provide any further comment?

(No response)

Section 2 - Park Types

The draft Strategy sets a vision for providing a diverse, multipurpose range of parks and reserves for our residents and visitors.

Do you agree with the types of parks being described in the draft Strategy?

(No response)

Are we missing anything in this area?

(No response)

Section 3 - Action Plan

The draft Strategy includes an action plan setting out short, medium, long term and ongoing projects.

Have we got our priorities and/or actions right in the proposed action plan?

(No response)

If you answered no, please explain where priorities should change or indicate where you think Council should invest:

(No response)

Section 4 - Final Comments

Do you have any other comments about the provision of parks and open space in the Queenstown Lakes District?

Barrier Free NZ Trust has been providing expert technical advice on how to ensure open spaces and buildings and constructions are as accessible as is possible for all people and to maximise the health

and wellbeing benefits to users. Our experience (significant work in Christchurch and Auckland), has evidenced the best process for ensuring the end result is as universally accessible and barrier free for all people, is to facilitate both a consultation with a variety of users with impairments, and the inclusion of a design and construction accessibility audit and report throughout the design and build process. This process (two streams), serves to inform the design team of the technical requirements/possibilities for both compliance and for best practice standard design (in so far as accessibility), consult and inform the disability community who will be using the park and facilities and through a continuous process of informing and consulting throughout the project, the goal of a genuinely usable and accessible space will be achieved (in as much as is possible). We seek Queenstown Lakes District to aim to be a best practice exemplar of accessibility and usability, to future proof the space for when the Human Rights and Building Act requirements align and expect accessible features in all spaces and to set the goal of best practice, not minimum compliance to the accessibility regulations. BFNZT provides a free accessibility helpline for brief queries and questions, but we recommend a formal independent accessibility audit is commissioned at the three stages - concept review, detailed plan, construction and that an organisation like BFNZT or equivalent is used, who can provide a reconciliation of the needs of all impaired user types, and can consult and communicate with the sector on why various features can and cannot be accessible and how that can occur.

Draft Parks Strategy

<https://fluidsurveys.com/account/surveys/1100420/responses/export//surveys/qldc/parks-strategy-notification/e944e8877fe59141627b4b87def9079de6d1f8e7/>

Filled Monday, November 28, 2016

Page 1

Your details

First Name:

Louise

Last Name:

Brown

Email Address:

tiaki_nz@hotmail.com

I am submitting as a:

- Resident / Ratepayer

Where in the district do you live?

Wanaka

Page 2

Section 1 - Distribution of Open Space

The draft Strategy provides guidance on how much and the types of open space should be available in communities across the district.

Are you happy with the amount and size of parks and open space in your community?

(No response)

Would you like to provide any further comment?

(No response)

Section 2 - Park Types

The draft Strategy sets a vision for providing a diverse, multipurpose range of parks and reserves for our residents and visitors.

Do you agree with the types of parks being described in the draft Strategy?

(No response)

Are we missing anything in this area?

(No response)

Section 3 - Action Plan

The draft Strategy includes an action plan setting out short, medium, long term and ongoing projects.

Have we got our priorities and/or actions right in the proposed action plan?

(No response)

If you answered no, please explain where priorities should change or indicate where you think Council should invest:

(No response)

Section 4 - Final Comments

Do you have any other comments about the provision of parks and open space in the Queenstown Lakes District?

(No response)

Draft Parks Strategy

<https://fluidsurveys.com/account/surveys/1100420/responses/export//surveys/qldc/parks-strategy-notification/5c9ed7dd86c8e76d9a922c2497cb8ef3ac2fd22a/>

Filled Tuesday, December 13, 2016

Page 1

Your details

First Name:

Maggie

Last Name:

Hillock

Email Address:

maggiehillock@gmail.com

I am submitting as a:

- Resident / Ratepayer

Where in the district do you live?

Arrowtown

Page 2

Section 1 - Distribution of Open Space

The draft Strategy provides guidance on how much and the types of open space should be available in communities across the district.

Are you happy with the amount and size of parks and open space in your community?

Yes

Would you like to provide any further comment?

Horses should be allowed to walk on all bike/walking trails.

Section 2 - Park Types

The draft Strategy sets a vision for providing a diverse, multipurpose range of parks and reserves for our residents and visitors.

Do you agree with the types of parks being described in the draft Strategy?

Yes

Are we missing anything in this area?

More horse riding/ combined walking trails.

Section 3 - Action Plan

The draft Strategy includes an action plan setting out short, medium, long term and ongoing projects.

Have we got our priorities and/or actions right in the proposed action plan?

Yes

If you answered no, please explain where priorities should change or indicate where you think Council should invest:

(No response)

Section 4 - Final Comments

Do you have any other comments about the provision of parks and open space in the Queenstown Lakes District?

More horse riding areas

Draft Parks Strategy

<https://fluidsurveys.com/account/surveys/1100420/responses/export//surveys/qldc/parks-strategy-notification/755166c15f7e56b96a96f09de8c27dfaf1dae218/>

Filled Thursday, December 15, 2016

Page 1

Your details

First Name:

Martin

Last Name:

Galley

Email Address:

discgolfwanaka@xtra.co.nz

I am submitting as a:

• Club / Organisation or School

Where in the district do you live?

Albert Town

Page 2

Section 1 - Distribution of Open Space

The draft Strategy provides guidance on how much and the types of open space should be available in communities across the district.

Are you happy with the amount and size of parks and open space in your community?

Yes

Would you like to provide any further comment?

Disc Golf Wanaka Incorporated Submission On QLDC Draft Parks Strategy

Disc Golf Wanaka Incorporated support QLDC's Draft Parks Strategy. Disc Golf is a passive recreational pursuit that works well with multi-use reserves. Disc Golf courses are designed to use seldom used parts of reserves and parks. We have one very popular course on Lismore Park and a second under development at Eely Point, Wanaka.

We aim to continue to grow the sport of Disc Golf through providing more courses for free public use in the future. Our courses are designed to be sympathetic to natural and other features and require minimal change to existing parks and can co-exist with walking and cycling tracks and other facilities.

We seek to continue our good relationship with QLDC and approve of the Draft Parks Strategy as one that meets our needs and ambitions.

Sincerely,

Martin Galley (Chairman) & Ed Waddington (Secretary),

Disc Golf Wanaka Incorporated

4 Wexford Street,

Albert Town

Wanaka 9305

Email discgolfwanaka@xtra.co.nz

(No response)

Section 2 - Park Types

The draft Strategy sets a vision for providing a diverse, multipurpose range of parks and reserves for our residents and visitors.

Do you agree with the types of parks being described in the draft Strategy?

Yes

Are we missing anything in this area?

(No response)

Section 3 - Action Plan

The draft Strategy includes an action plan setting out short, medium, long term and ongoing projects.

Have we got our priorities and/or actions right in the proposed action plan?

Yes

If you answered no, please explain where priorities should change or indicate where you think Council should invest:

(No response)

Section 4 - Final Comments

Do you have any other comments about the provision of parks and open space in the Queenstown Lakes District?

(No response)

Draft Parks Strategy

<https://fluidsurveys.com/account/surveys/1100420/responses/export//surveys/qldc/parks-strategy-notification/b8a1faa11122df0e76dfdb354b45073a8e66d0c3/>

Filled Wednesday, December 07, 2016

Page 1

Your details

First Name:

michael

Last Name:

lynds

Email Address:

malynds@gmail.com

I am submitting as a:

- Resident / Ratepayer

Where in the district do you live?

Wanaka

Page 2

Section 1 - Distribution of Open Space

The draft Strategy provides guidance on how much and the types of open space should be available in communities across the district.

Are you happy with the amount and size of parks and open space in your community?

Yes

Would you like to provide any further comment?

(No response)

Section 2 - Park Types

The draft Strategy sets a vision for providing a diverse, multipurpose range of parks and reserves for our residents and visitors.

Do you agree with the types of parks being described in the draft Strategy?

Yes

Are we missing anything in this area?

(No response)

Section 3 - Action Plan

The draft Strategy includes an action plan setting out short, medium, long term and ongoing projects.

Have we got our priorities and/or actions right in the proposed action plan?

Yes

If you answered no, please explain where priorities should change or indicate where you think Council should invest:

(No response)

Section 4 - Final Comments

Do you have any other comments about the provision of parks and open space in the Queenstown Lakes District?

I think the plan is clear and concise. One aspect I would like to make a submission about is sticky forest in Wanaka.

I believe it should be a high priority of the council to protect this recreational area. It is a huge asset to Wanaka as a whole, I'm an keen mountain biker and if this land were to be re-zoned and developed it would be a huge loss to the area as its the main area for mountain biking in Wanaka. I believe it has developed into a recreational area that is used by many aspects of the community and visitors, almost every time I ride up there I see other people using it, whether they are on bikes or running, walking and sight seeing. I often come across tourists in there on hire bikes and visitors on bikes who have heard of the great trails in the forest and who have come to wanaka to ride them.

I think Wanaka as a whole benefits from it. Local businesses who hire, sell and repair bikes would take a hit if it were to be developed. It brings keen mountain bikers to the town also and gives tourists another free activity which is a massive benefit in a expensive resort town.

With Wanaka developing so fast as a whole, especially on that side of town it would serve as the perfect place for a reserve. The land is being developed on all sides and in the plan it states there should be a reserve within 600m of any house, with all the subdivisions being developed in the surrounding area sticky forest would be a huge asset to these new communities.

With mountain biking growing so rapidly as a sport, especially in this region it would be such a massive loss to wanaka if we were to loose this great resource that is sticky forest, and I hope the council are actively looking for ways to protect it.

Thanks,

Mike Lynds.

Draft Parks Strategy

<https://fluidsurveys.com/account/surveys/1100420/responses/export//surveys/qldc/parks-strategy-notification/c85904230d78f7b7e6216fe47b8bd57cc1407625/>

Filled Monday, November 28, 2016

Page 1

Your details

First Name:

Niall

Last Name:

Sutherland

Email Address:

n.z.sutherland@hotmail.co.uk

I am submitting as a:

- Resident / Ratepayer

Where in the district do you live?

Wanaka

Page 2

Section 1 - Distribution of Open Space

The draft Strategy provides guidance on how much and the types of open space should be available in communities across the district.

Are you happy with the amount and size of parks and open space in your community?

No

Would you like to provide any further comment?

Too much land is being taken up by housing to the point that the Town is out growing itself. Areas and facilities that locals use and love are being destroyed to make way for more money makers. Especially poignant is the use of Sticky Forest and it's safety for the future.

Section 2 - Park Types

The draft Strategy sets a vision for providing a diverse, multipurpose range of parks and reserves for our residents and visitors.

Do you agree with the types of parks being described in the draft Strategy?

No

Are we missing anything in this area?

Open access land just like Sticky Forest!

Section 3 - Action Plan

The draft Strategy includes an action plan setting out short, medium, long term and ongoing projects.

Have we got our priorities and/or actions right in the proposed action plan?

No

If you answered no, please explain where priorities should change or indicate where you think Council should invest:

Priorities need to be with current and existing residents and not the use of land for building new holiday homes.

Section 4 - Final Comments

Do you have any other comments about the provision of parks and open space in the Queenstown Lakes District?

Open space is what draws people to this incredible area. Without that we become just like anywhere else and devalue this incredible environment. If we can not look after the place that we love and work for then the value of everything we have at the moment will diminish. Sticky Forest simply must remain as a recreation area and should never be used to create housing.

Draft Parks Strategy

<https://fluidsurveys.com/account/surveys/1100420/responses/export//surveys/qldc/parks-strategy-notification/0d680067c3c65122c75fa7f5e8f79aebacfdcca3/>

Filled Monday, December 12, 2016

Page 1

Your details

First Name:

Phillipa Cook

Last Name:

Kelvin Peninsula Community Association

Email Address:

talk2kpca@gmail.com

I am submitting as a:

- Club / Organisation or School

Where in the district do you live?

Kelvin Heights

Page 2

Section 1 - Distribution of Open Space

The draft Strategy provides guidance on how much and the types of open space should be available in communities across the district.

Are you happy with the amount and size of parks and open space in your community?

No

Would you like to provide any further comment?

(No response)

1. Accessibility – All residents within urban/built up areas should live within reasonable walking distance to a Local Park. Pathways to the reserves should be easy for parents with young children, people with limited mobility and the elderly. This is becoming increasingly important with the ageing population.

Unfortunately, at the Frankton end of the peninsula there are no parks or reserves until Bayview reserve, a considerable distance for the residents and visitors to the Queenstown Hilton Hotel and some consideration is necessary to adhere to the strategy. And as you are aware we have an ageing population on the peninsula which require close amenities

2. Community Park – we are fortunate to have Jardine Park on the peninsula and as you are aware we have the KPCA workgroup and an Adopt a Plot programme working in the park and along the trails. However, there is no socialising area including picnic and BBQ facilities both of which are mentioned in the strategy.

We look forward to receiving your comments.

KPCA Committee

(No response)

Section 2 - Park Types

The draft Strategy sets a vision for providing a diverse, multipurpose range of parks and reserves for our residents and visitors.

Do you agree with the types of parks being described in the draft Strategy?

Yes

Are we missing anything in this area?

Community Park – we are fortunate to have Jardine Park on the peninsula and as you are aware we have the KPCA workgroup and an Adopt a Plot programme working in the park and along the trails. However, there is no socialising area including picnic and BBQ facilities both of which are mentioned in the strategy.

(No response)

Section 3 - Action Plan

The draft Strategy includes an action plan setting out short, medium, long term and ongoing projects.

Have we got our priorities and/or actions right in the proposed action plan?

Yes

If you answered no, please explain where priorities should change or indicate where you think Council should invest:

(No response)

Section 4 - Final Comments

Do you have any other comments about the provision of parks and open space in the Queenstown Lakes District?

Thank you for the opportunity to be a part of this valuable strategy, we appreciate it.

The strategy is very detailed and only 2 points have come to our attention which relate to the Kelvin Peninsula and its reserves

1. Accessibility – All residents within urban/built up areas should live within reasonable walking distance to a Local Park. Pathways to the reserves should be easy for parents with young children, people with limited mobility and the elderly. This is becoming increasingly important with the ageing population.

Unfortunately, at the Frankton end of the peninsula there are no parks or reserves until Bayview reserve, a considerable distance for the residents and visitors to the Queenstown Hilton Hotel and some consideration is necessary to adhere to the strategy.

2. Community Park – we are fortunate to have Jardine Park on the peninsula and as you are aware we have the KPCA workgroup and an Adopt a Plot programme working in the park and along the trails. However, there is no socialising area including picnic and BBQ facilities both of which are mentioned in the strategy.

We look forward to receiving your comments.

KPCA Committee

(No response)

Draft Parks Strategy

<https://fluidsurveys.com/account/surveys/1100420/responses/export//surveys/qldc/parks-strategy-notification/3a9e5cf9472aaeeca93cca2e20c44f7d941e3356/>

Filled Monday, December 12, 2016

Page 1

Your details

First Name:

Roger

Last Name:

Gardiner

Email Address:

gardiner@outlook.co.nz

I am submitting as a:

- Resident / Ratepayer

Where in the district do you live?

Wanaka

Page 2

Section 1 - Distribution of Open Space

The draft Strategy provides guidance on how much and the types of open space should be available in communities across the district.

Are you happy with the amount and size of parks and open space in your community?

Yes

Would you like to provide any further comment?

As the town grows Council should ensure sufficient land is set aside for parks. Was concerned to hear that in North Lake Subdivision, land set aside for storm water disposal, has been treated as part of the developers reserves contribution. I hope this is not the case

Section 2 - Park Types

The draft Strategy sets a vision for providing a diverse, multipurpose range of parks and reserves for our residents and visitors.

Do you agree with the types of parks being described in the draft Strategy?

Yes

Are we missing anything in this area?

By way of note, interesting that neither the Faulks Terrace Recreational Reserve, or the Stone St reserve was listed/mentioned as an example.

Section 3 - Action Plan

The draft Strategy includes an action plan setting out short, medium, long term and ongoing projects.

Have we got our priorities and/or actions right in the proposed action plan?

No

If you answered no, please explain where priorities should change or indicate where you think Council should invest:

(No response)

Section 4 - Final Comments

Do you have any other comments about the provision of parks and open space in the Queenstown Lakes District?

I have read the document and will make a submission around a couple of operational/management issues. This may or may not be the correct forum.

1. The local Parks and Reserves staff advise that they have abandoned the previous practise of spraying around trees for grass/weed suppression. This is crazy as in our dry summers, where the grass competes with the tree roots for moisture. The reason for this new policy is hard to fathom. I think has something to do with the contractor and the accuracy of his spraying..... Well fire the contractor. In critical areas like the approaches to the town, trees planted by the old Wanaka Residents Association many years ago, would benefit from careful spraying . I have offered to do this task personally but this was met with a blanket NO !!! We need a more flexible policy where members of the public may with Council approval, contribute volunteer work around care and maintenance of reserves. In particular maintenance of trees that were donated and planted by community organisations.

An option might be for example for council to host appropriate training (spray & handling for example), so that members of the public, if they choose, can then contribute to the effort required to look after parks in their neighborhood

2. All reserves should have visible and appropriate signage. Information should include name of the reserves and any other provisions regarding use/activities.

3. Policy/procedures to be defined where opportunity exists for park friends and neighbours to donate facilities, e.g. park seats

4. Suggest a small QLDC grant or support to fund annual Neighborhood Park picnics. Held in Summer, purpose would be for neighbors of nearby Parks to get together and enjoy the park in their locality. This would foster a sense of value, care and ownership.

(No response)

Draft Parks Strategy

<https://fluidsurveys.com/account/surveys/1100420/responses/export//surveys/qldc/parks-strategy-notification/7c8a96ab257c2b3625c85be3b7e96395ee400e96/>

Filled Monday, December 12, 2016

Page 1

Your details

First Name:

Susan

Last Name:

Harwood

Email Address:

suze.h@xtra.co.nz

I am submitting as a:

• Club / Organisation or School

Where in the district do you live?

Arrowtown

Page 2

Section 1 - Distribution of Open Space

The draft Strategy provides guidance on how much and the types of open space should be available in communities across the district.

Are you happy with the amount and size of parks and open space in your community?

No

Would you like to provide any further comment?

I am submitting on behalf of the Wakatipu Riding Club, Inc., as President. We are an active, local club with over 70 adult horse owners/riders, and growing. I would like to express our concerns as described below.

Section 2 - Park Types

The draft Strategy sets a vision for providing a diverse, multipurpose range of parks and reserves for our residents and visitors.

Do you agree with the types of parks being described in the draft Strategy?

No

Are we missing anything in this area?

The Wakatipu Basin is missing a dedicated open space for horseback riding; specifically, for horse owners/riders, not commercial trekking companies. There are well over 100 horses and ponies in the Wakatipu Basin area that are ridden by children and adults on a regular basis. Other than a handful of privately-owned arenas and paddocks, there is no flat land available on which to exercise and train these horses/ponies and their riders. Equestrian sport is extremely popular in NZ, and especially here with a concentrated number of horses and riders in a small geographic area. Unfortunately, the local NZ Pony Club branch does not have permanent grounds, nor does the Wakatipu Riding Club. And, the cost of land in the basin prohibits either club from purchasing . Thus, we must rely on the goodwill of private land owners, which can change at any time. Therefore, we are appealing to the QLDC to identify and provide some land (minimum size approximately 5 acres) for horse riding and float parking, where riders can exercise their horses and ponies, as well as a place where riding instruction and competitions can be organised. There is currently a proposal to vest some land at Shotover Country for this purpose, which we would like to see prioritised ASAP.

Section 3 - Action Plan

The draft Strategy includes an action plan setting out short, medium, long term and ongoing projects.

Have we got our priorities and/or actions right in the proposed action plan?

No

If you answered no, please explain where priorities should change or indicate where you think Council should invest:

We would also like to see the provision for more (off road) horse riding trails, specifically some shared trails with pedestrians and bicycles using the existing cycle trail network. There are many examples around NZ of shared trails, most notably the Central Otago Rail Trail. The current NZ Cycleways network here in the basin has places where horse riding could be conducted safely along with the walkers and cyclists. Basically, any trail that is wide enough (3 metres) and straight enough to provide good visibility and clearance for users to pass, could be used for all three activities. We would be happy to work with the QLDC and the Queenstown Trails Trust to help identify these sections of the trails. In fact, we have already provided a list of trails to QLDC who, I believe, are in the process of reviewing it....so, let's please make it a priority.

Section 4 - Final Comments

Do you have any other comments about the provision of parks and open space in the Queenstown Lakes District?

We would also like to explore the creation of new horse riding trails in the district. There are large tracks of land currently under management by QLDC that might accomodate horse riding using existing 4WD tracks. The Coronet Forestry, where the Wakatipu Riding Club already has 5-year License to Occupy, is a great example. In addition, we would like to be given first priority to work with QLDC once the trees have been cut and cleared in the forestry to develop a larger network of trails on the hill, specifically for horse riding. Currently, this is the ONLY place in the entire Wakatipu where horses can be safely ridden without motorists....we could really use additional trails that are off road. Another option is to explore the possibility of using existing 4WD tracks in the Soho Properties land. Thank you for the chance to provide input.

PROPOSAL OUTLINE.

The Wanaka Associated Football Club present this submission to address the following matters and offer some possible solutions for council consideration and support.

1. The identified shortfall of adequate sports grounds in Wanaka.
2. Lack of facilities and the inability to develop football facilities on the current Pembroke Park.

Short Term Solutions:

1. Wanaka Recreation Centre

Develop the planned two playing fields at the Wanaka Recreation Centre.

Include basic sports facilities. Particularly flood lights and changing rooms.

2. Kellys Flat Reserve

Increase the development at Kellys Flat to help facilitate current needs and further growth.

Long Term Solutions

1. Ballyntyne Rd Oxidation Ponds

Develop Ballyntyne Rd Oxidation ponds land into sports fields to facilitate the future growth of the town and address the long term shortfall.

BACKGROUND

The Wanaka Associated Football Club Incorporated (WAFC) has been an incorporated society since August 2005. WAFC is a non profit organisation registered with Charities Services. The club organises and offers football training and competition to local junior players aged 5 years to 17 years of age.

WAFC participate in regional competition (with teams from Wanaka, Alexandra, Cromwell and Queenstown). WAFC are also affiliated with a national body. That being Football South which is one of the seven federations established by New Zealand Football. For further information about our club you can view our website. www.wanakafootball.org.nz

Junior football has had a rapid rise in popularity in recent years in Wanaka. Since 2014 the number of children that are playing for our club increased from 160 children to 340 children. A 100% increase over two years. As a consequence there has been a greater demand for more football fields, equipment, coaches and infrastructure to accommodate this growth. In addition there are now three senior mens teams up from one team four years ago and there are also three Mt Aspiring College football teams.

With both the popularity of the sport and the increased population growth of the region. Already the WAFC has reached capacity to accommodate the current players and teams with the available facilities and sports fields in Wanaka.

CLUB ISSUES

Currently in order to accommodate the large numbers of teams at practice and on regional tournament days, The club has to spread itself over two venues. Kellys Flat and Pembroke Park.

Kellys Flat

Kellys Flat is a great location for football training because of its position close to the Wanaka Schools zone. But it has unfortunately already reached maximum capacity.

With the increasing school roles at Wanaka Primary School and Mt Aspiring College it will soon be too small to accommodate all the junior players and teams. Already many teams have had to shift to Pembroke Park for training.

The demand is so great, that an overflow area (of non developed sports field) is required to accommodate the under 6 teams even though this area is sloping and the turf has large areas of mown broom bush on it.

- The rugby club are using Kellys Flat for touch rugby this summer and they have had to mark out pitches on this undeveloped area as well.

Loss of MAC Sports Field.

Since the start of 2016 there is no longer a football field at Mt Aspiring College due to the expanding role at the school, classrooms have been built on the area which was previously used as a football field.

Pembroke Park

Because of the loss of Mt Aspiring College football field. The club now uses Pembroke Park for training and game days.

In Feb 2016 WAFAC applied to QLDG to use Pembroke Park. The initial response from QLDG was the concerns about the difficulty of making this happen, this was feedback from the contractor and issues regarding marking the fields alongside other sports codes using the grounds. Eventually a compromise to use different colours to mark the grounds enabled WAFAC to utilize this facility. This wasn't ideal but it was a solution.

Pembroke Park reached full capacity on training days this year, the club managed this by organising teams to train on different days of the week. It is also at capacity on competition days with games starting at 8.30am and finishing after 4pm in winter.

In 2017, with expected continued growth, more sports fields will be needed for regional competition days. It is still unclear how this will be managed.

In 2018 the two new fields at the Wanaka Recreation Centre will be available for use. A welcome outcome, but will result in the WAFAC tournaments being spread over three venues to accommodate the needs of the club.

Multiple Venues across town

From 2018 WAFAC will have three different venues across town for hosting regional competition days. Logistically this becomes really difficult and is a real issue for parents that have children playing in different age group teams and have to spread themselves between all three venues across town at one time. Compare this to Queenstown when they have competition days everyone is catered for at the Event Centre. Regional competitions at present accommodate about 1000 junior football players from Wanaka, Queenstown, Alexandra and Cromwell. These competition days bring lots of families into town and this has a positive flow on economic benefits to the town.

Facilities.

The club is fully aware of the limitations and restrictions placed on them in using Pembroke Park. As the club grows so will the need for facilities such as Changing Rooms/ Toilets/ Pitches with flood lights and even one day a Club Rooms. These facilities will never be allowed on Pembroke Park.

With the expected continued growth of the club it is really important to have a sports ground available where these facilities could be constructed.

1. Changing Rooms.

At present Pembroke Park provides no changing rooms, water to fill drink bottles or toileting. Wanaka is the only club in the region that lacks these facilities at their sports ground. This is of particular embarrassment to the senior teams when compared to other clubs in the region.

This is also a big issue for girls that play football. At present girls total approximately 15% of the total player numbers in the junior club. (Players aged 5 – 17 years old.) There is currently nowhere at Pembroke Park for girls to get changed, many of these girls play two games on the same day and are from out of town.

2. Flood lights

There are no current football fields in Wanaka that have flood light facilities. This is a big issue for the senior teams that have to train at night after work in winter. Teams pay fees to use Pembroke Park, but then have to negotiate for times to train at the rugby grounds for their flood lights. The rugby grounds

are not suitable for a number of reasons and whilst the senior teams really appreciate having somewhere to train, the grass is too long, there are no football goals and there is nowhere to change or shower. The number of senior teams is growing fast and soon even the rugby grounds won't be enough.

Flood lights extend the daylight hours during winter. This is very important as the junior club rely on coaches that volunteer their time to the kids. At present all training has to be done during work hours (before it gets dark at 5.30pm). Some potential coaches are not able to leave work to volunteer their time. A floodlit football facility would enable some junior teams to be able to train in the evenings after work hours.

RELEVANT QLDC PARKS STRATEGY CLAUSES

1. In reference to the QLDC Parks Strategy 2002 Document, here is the clause related to Sports Grounds as shown below in italics. This clause has been included to highlight the point that the current Pembroke Park facility does not actually meet this definition of a Sports Ground.

1.7 Sports Grounds – Mixed Use

A sports ground is a reserve that is designed for and used for active sport, primarily of a traditional team nature. The reserve will have formally maintained sports turf for a mixture of winter and/or summer sport. The sports turf areas are maintained to an appropriate standard for the sports code use.

Toilets, changing facilities and car parking are likely to be available and some reserves may have resident sports club facilities. Clubs may have constructed floodlights to enable evening training.

Pembroke Park will never meet this criteria. Toilets are an inconvenient distance from the playing fields. There are no changing facilities or flood lights and it will never be possible to build changing rooms or install floodlights on Pembroke Park. It would be impossible to get consent to build a club rooms on Pembroke Park.

WAFC see Pembroke Park as only a temporary location for sports fields in Wanaka. With the rapid growth in the town Wanaka will soon need to establish a Sports Ground that can meet the required standard and be in a location that is capable of installing the facilities and infrastructure as per the QLDC Parks Strategy.

2. The QLDC Parks Strategy 2002 already identified the likely shortfall of sports grounds in Wanaka as per extracts in italics from the current document below.

3.8 Summary of land required by population number

This strategy identifies that there is likely to be a shortfall of the following categories of reserve, based on expected growth over the next 20 years. These probable shortfalls should be reviewed again as part of the strategy review in 2012 (ten year review).

Wanaka

Sports Grounds Mixed Use, shortfall 70,000m²

Wanaka while currently provided for has limited opportunities for developing further grounds, although the Showground would benefit from reconfiguration which may provide an additional winter field and separate training ground. There maybe scope for sporting use of the adjoining Pembroke Park in future years subject to the management plan review identifying this as an appropriate use. There is merit in looking to acquire land for sports ground development in the medium term (20 + years). The median growth projections indicate population growth to 7,100 (Wanaka Area Unit) people by 2021, although with a slightly increasing average median age. For this reason, and to assist Mt

Aspiring College manage growth, it is recommended that future demand (short to medium term) for sports fields be accommodated on the south side of Aubrey Road on part of the Scurr Heights property.

Since this document became the active Parks Strategy, Wanaka has gained Kellys Flat reserve as a Sports Field but lost the use of Mt Aspiring College (Due to expanded role and class rooms being built on the football field). The Wanaka Recreation Centre at Three Parks will eventually have two additional playing fields.

The current state of holding sports events in Wanaka has been to cram everything onto Pembroke Park. (Even though it is questionable that this is appropriate usage for Pembroke Park). Currently it is multi use with field markings from different codes painted on top of each other in different colours to distinguish between the different usage. We see Pembroke Park as only a temporary solution to the problem. It does not have any facilities for sport and it would be very unlikely to get consent to add facilities in the future as identified above.

The population growth in Wanaka has exceeded the projections in the Parks Strategy report. As an example of this, the Wanaka Junior Football club has grown 100% in the last two years from 160 junior players to 340 junior players. It is now a bigger club, with more players and teams than the Queensdown junior football club.

3. Further extracts from the QLDLC Parks Strategy 2002 in italics below.

3.2 Sports Grounds – Mixed Use **Quantity / size of land**

Sports grounds are best provided centrally to service local communities and where possible enough land should be provided to ensure several playing surfaces can be developed in time as demand requires. It is recommended that the minimum future provision be of a size that accommodates four full size winter fields (approximate dimension 130 x 80 metres each equal to approximately 1 hectare per winter field) and also provides suitable land for onsite car parking, facility development and off field training grounds.

Usable flat land to meet the above requirement will equate to a minimum parcel of land of 7 hectares, this will essentially only apply to Wanaka as Queensdown and Arrowtown have been provided for through the Queensdown Events Centre.

SUMMARY

There is a current shortfall in available sports fields in Wanaka. As identified by the current 2002 Parks Strategy at least 70,000m² of Sports Ground are required now in the Short Term. Even a couple of playing fields at the Wanaka Recreation Centre on Ballantyne Rd is not going to meet the immediate needs of the community.

The opportunity to develop sports grounds near the college has been lost due to the residential growth in the area and the nature of the land topography around the school would make it difficult to develop sports fields there anyway.

The new Wanaka Recreation Centre was built in the Three Parks Subdivision, this now becomes the obvious location to centralise sports grounds in Wanaka. Although it is not close to the current schools, if sports grounds were established in this area then it would become an attractive location for any future campus. There are only two fields planned at the new Wanaka Recreation Centre. I would like to point out that this does not meet the required quantity / size of land as documented in the 2002 Parks Strategy above and does not provide for any future demand

POSSIBLE SOLUTIONS

The Sites:

1. Ballantyne Oxidation Ponds

101 Ballantyne Road WANAKA RURAL 9382.

SEC 1 SO 17808

(20ha approx)

The council currently own the flat ground adjacent to the Wanaka Rec Centre at Three Parks. The now redundant oxidation ponds on Ballantyne Road could potentially be turned into sports fields. The site has good topography for developing. It is large enough for several playing surfaces that can be developed as demand requires, accommodate onsite car parking and other facility development like changing rooms and a club house.

This is a great location for the future sports fields because of its close proximity to the Wanaka Recreation Centre. The Oxidation Ponds site in Ballantyne Rd, is currently owned by council so land acquisition would not be required.

The 2002 Parks Strategy identified the Scurr Heights property as a location to develop sports fields in the short term. This property has now been sold by the council. It would not be unreasonable then to expect the profit from this sale to be put back into the Wanaka community by developing sports fields, particularly when a shortfall was identified 15 years ago and is now a reality.

If football then moved to this site, Pembroke Park could be freed up for other users.

2. Kelly Flat

Kellys Flat is legally described as Kellys Flat Recreation Reserve - Section 93 Blk XIV Lower Wanaka SD (3 ha).

In 2013 Kellys Flat reserve was upgraded by QLDC and landscaped to facilitate organised sport. This upgrade was all done as part of the QLDC Kellys Flat Management Plan 2008.

Since then the Wanaka Junior Football club has been using the Kelly flat sports ground for training and competition days for junior football teams. The facility has proved to be very good and a much needed improvement from the old Mt Aspiring College grounds previously used. The availability of Kelly Flat Sports Ground last year was also very timely with the huge growth in junior player numbers.

That being said Kelly Flat is already at capacity. U6 pitches are on a slope and played on mown broom.

3. Wanaka Recreation Centre

QLDC have planned to develop two outdoor playing fields at The Wanaka Recreation Centre in Ballantyne Rd. There is an area allocated for these fields adjacent to the indoor centre, Budget has recently been allocated to develop this area into playing fields and these will likely be available for use in late 2017 or 2018.

Changing Facility. The scheme plan for these fields shows a toilet located between the proposed football fields and the ¾ size hockey turf. This should be upgraded to include changing rooms and showers.

Floodlights. There are going to be floodlights install for the ¾ size hockey turf next to these football fields. This could be increased to include flood lighting for the football fields. It would be cost effective to install the power cables for this when the irrigation is being installed for the football fields.

COUNCIL SUPPORT

We seek Council support for the following:

1. Agree to include the development of further sports field in Wanaka into the Parks Strategy Plan and QLD Council Annual Plan. Particularly the Ballantyne Rd, Oxidation Pond location for longer term planning. Plan to shift football and other sports off Pembroke Park and create a hub for sport in the Ballantyne Rd area in conjunction with the newly developed Wanaka Recreation Centre.
2. Include in the development of the Wanaka Recreation Centre grounds sports facilities. Flood lights and changing rooms.
3. Document a management plan and process to implement this.
4. Begin the process of allocating budget for these development.

Submission prepared by
Richard Vorstermans
Wanaka Associated Football Club

Ph: 027 2070157
e-mail: rich@hotmail.co.nz

APPENDIX 1 – Growth Projections
APPENDIX 2 – Maps
APPENDIX 3 – Letters of Support

APPENDIX 1 – GROWTH PROJECTIONS: JUNIOR FOOTBALL IN WANAKA

1. Wanaka Growth as a percentage whole.

Information From QLDC web site based on census data

The following 2013 Census Resident Population Counts were released on 15 October 2013.

Area	2001	2006	2013	% increase 2006-13
Wanaka	3,330	5,040	6,474	28.5%

If this growth rate remained consistent over the next seven years until 2022 and was simply applied to our current player numbers of 342, this would equate to an additional increase of 97 players over the next 7 years.

But can we expect even more increased rates of growth in junior football over this period?

2. Age and sex of people in the Queenstown Lakes District

Graph also from the 2013 census data

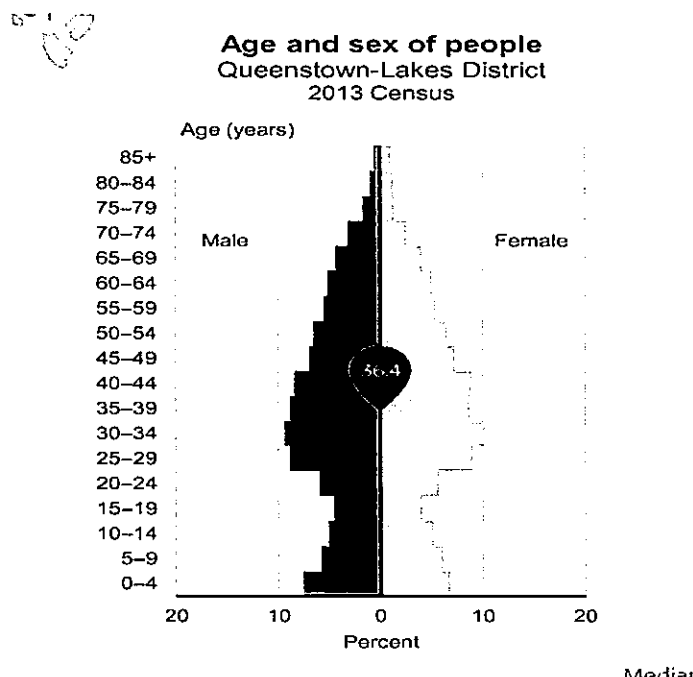

This graph shows that football aged children 5-18 as a smaller percentage of the population compared to younger children 0-4 years old. This younger 0-4 year age group bubble are now reaching the age to participate in sport and may give some reason why the club has had a large increase in player numbers over the last few years and why we can expect the number of children playing sport to increase at a greater rate than the overall population growth rate.

Add to this the increasing popularity and growth of girls football nationally. This growth has been identified and encouraged by New Zealand Football who have been implementing plans and frameworks to grow the participation of girls in football. Our region has a huge potential increase in growth from girls that are currently only 15% of total player numbers.

3. Calculated growth in Wanaka Junior Football Club models.

Compounding Growth Model

The last two years have seen phenomenal growth. We will not know until final figures are in next year if this will repeat but have to assume we cannot have such exponential growth repeat.

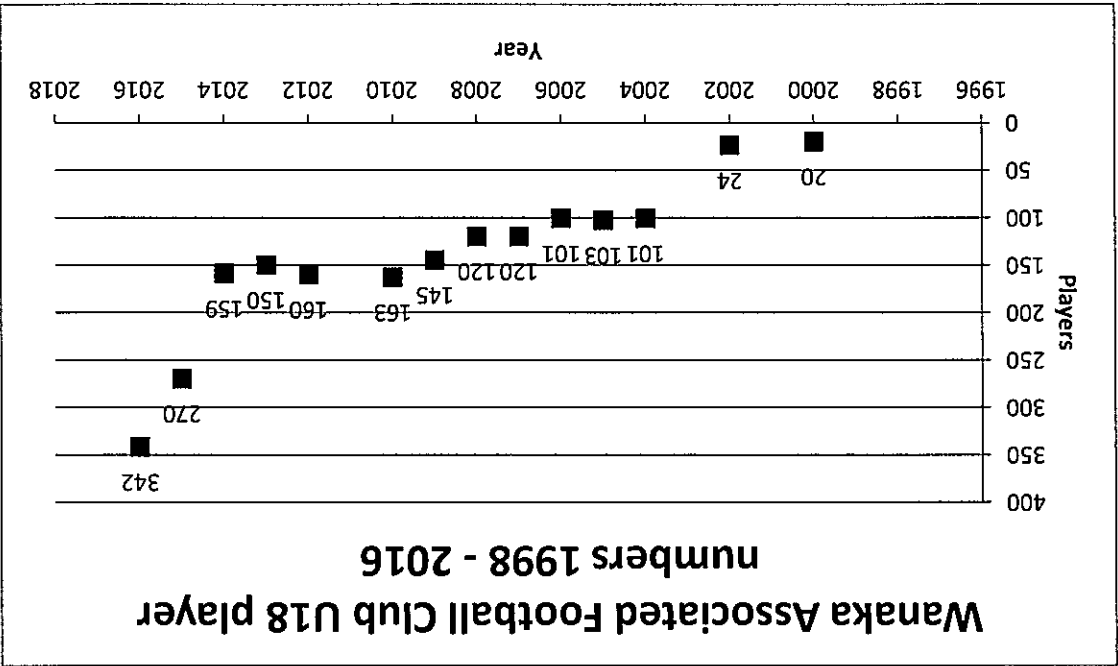

To turn to a more conservative view we could simply apply an arbitrary growth figure and compound this over several years. The following table uses 2.5%, 5%, 7.5% and 10% respectively as the compounding figure.

2016	2017	2018	2019	2020	2021	2022
342	351	359	368	378	387	397
342	359	377	396	416	436	458
342	368	395	425	457	491	528
342	376	414	455	501	551	606

This compounding model is a little simple as the percentage growth should reduce as the club size increases. With pure guess work to account for an expected reduction in percentage growth the following table breaks out two scenarios (wholly arbitrary growth figures used):

- 10% growth for 2 years; 7.5% for the following two years and then 5% for the next two years.
- 10% growth year one; 7.5% year two; 5% year three and then 2.5% ongoing

2016	2017	2018	2019	2020	2021	2022
342	376	414	445	478	502	527
342	376	404	425	435	446	457

If we use 457 as the projected number of players in 2022 this will translate into another 15 teams compared to 2016.

Summary

Conservatively through to 2022 we are looking at another 120 players but it does not take much to project an additional 200 players.

APPENDIX 2 - MAPS

LOCATION MAP. WANAKA TOWN

Note the geographic separation between the three football field locations at present

- Kellys Flat
- Pembroke Park
- Wanaka Recreation Centre (From 2018)

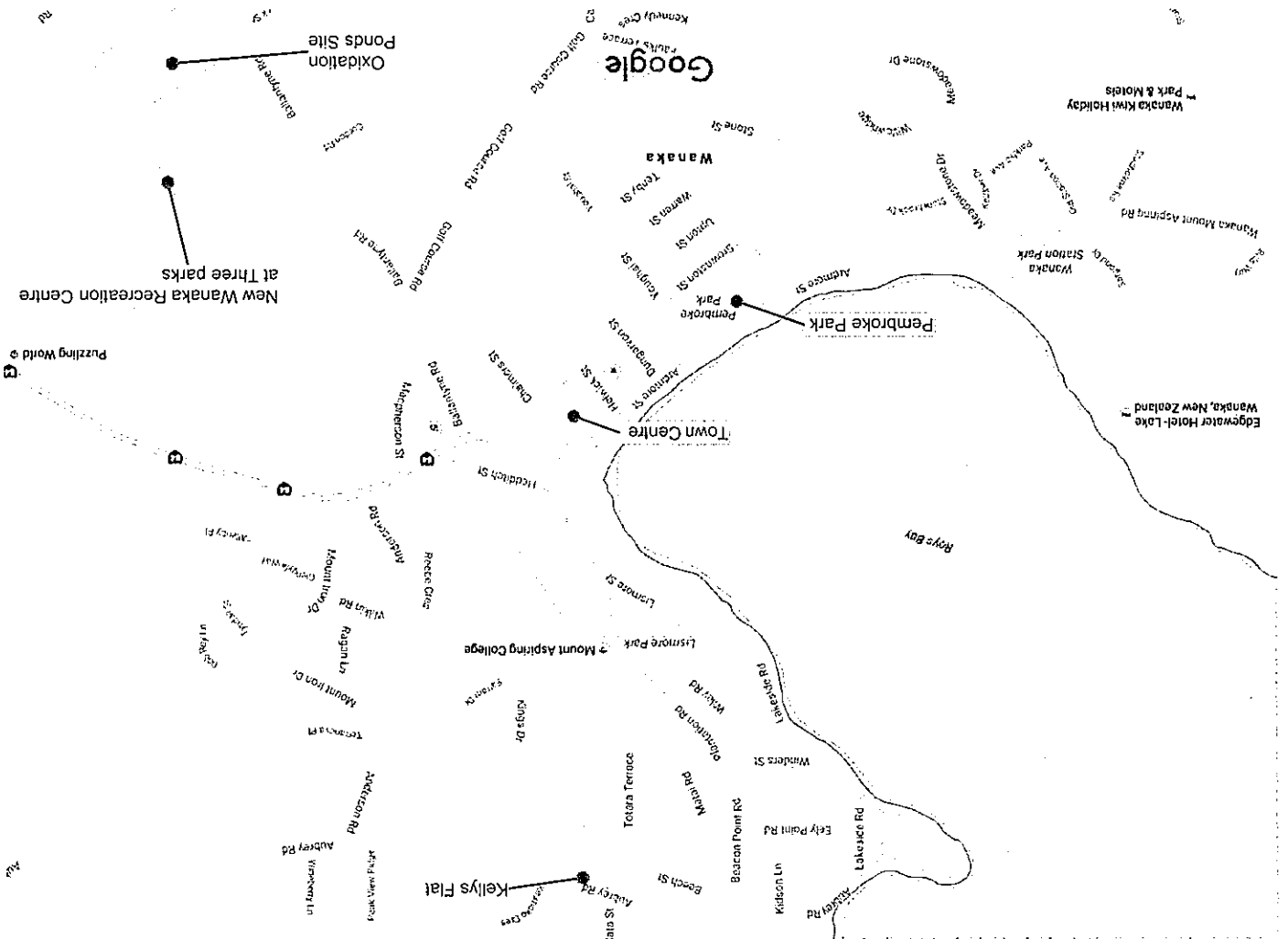

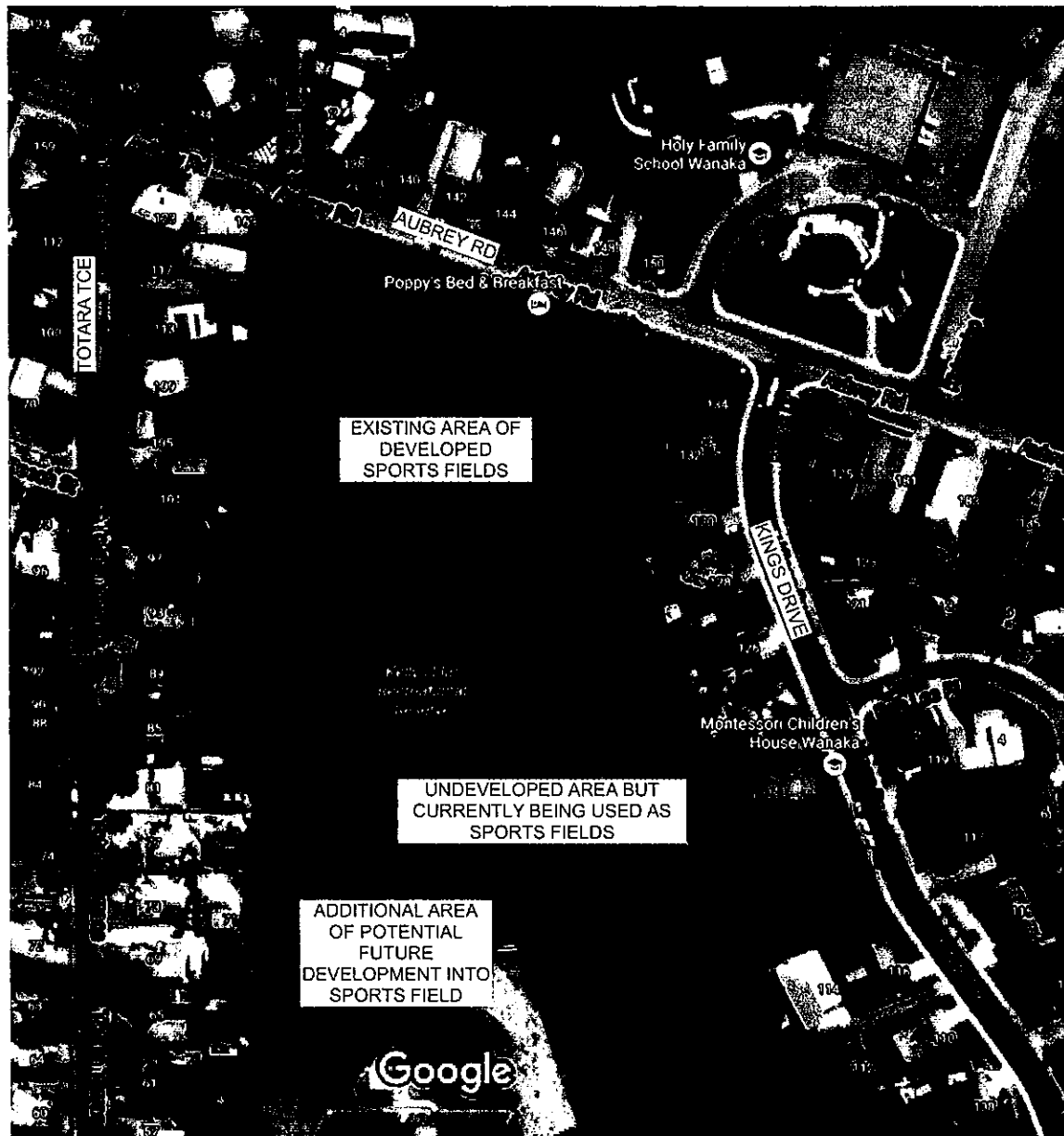

KELLYS FLAT.
AREA OF EXISTING AND POTENTIAL SPORTS
FIELD DEVELOPMENT

The undeveloped area of Kellys Flat is currently being used for organised sport

- U6 Football pitches in winter
- Touch Rugby this summer

BALLANTYNE RD: LOCATION PLAN



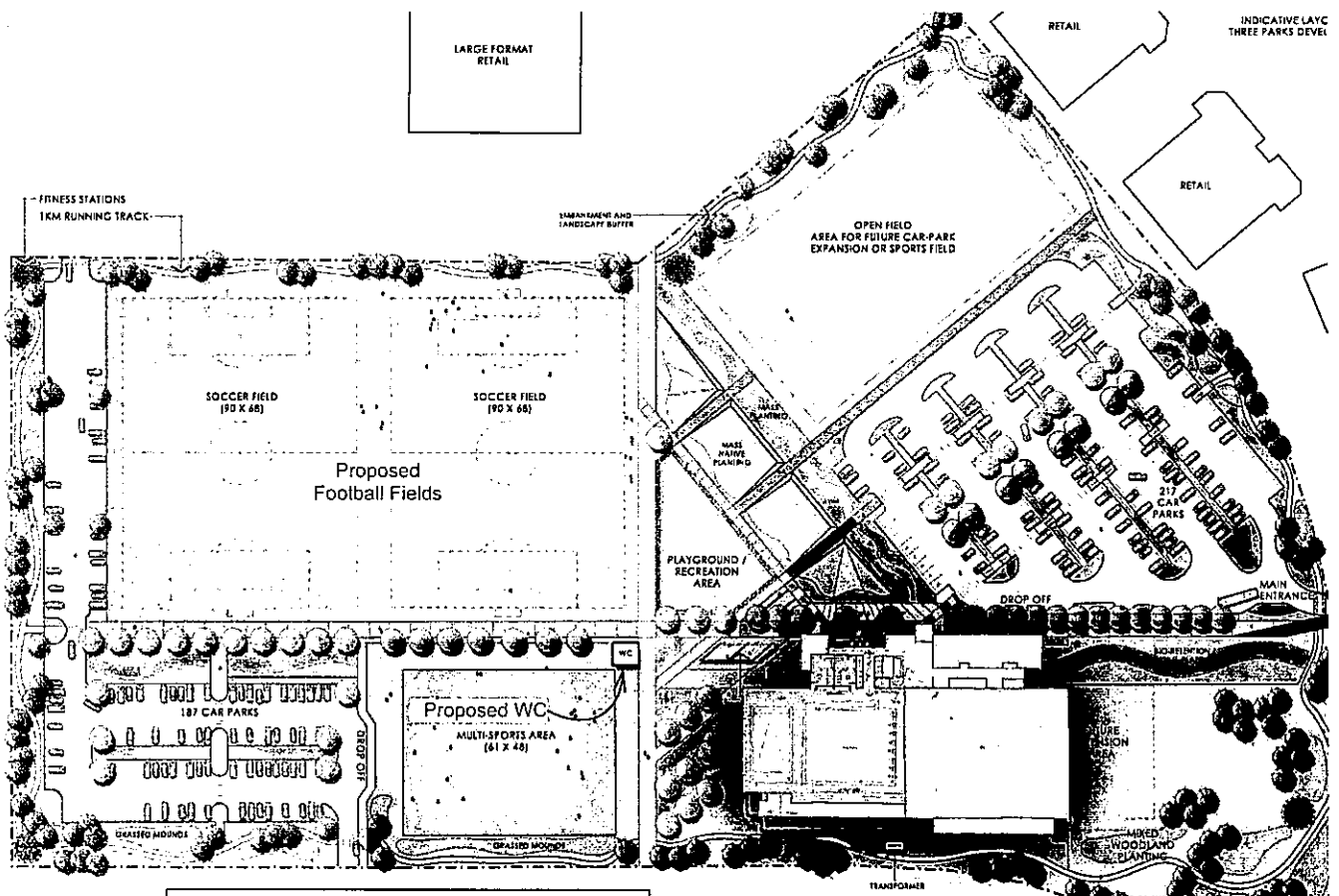

EXISTING LAYOUT
WANAKA RECREATION CENTRE

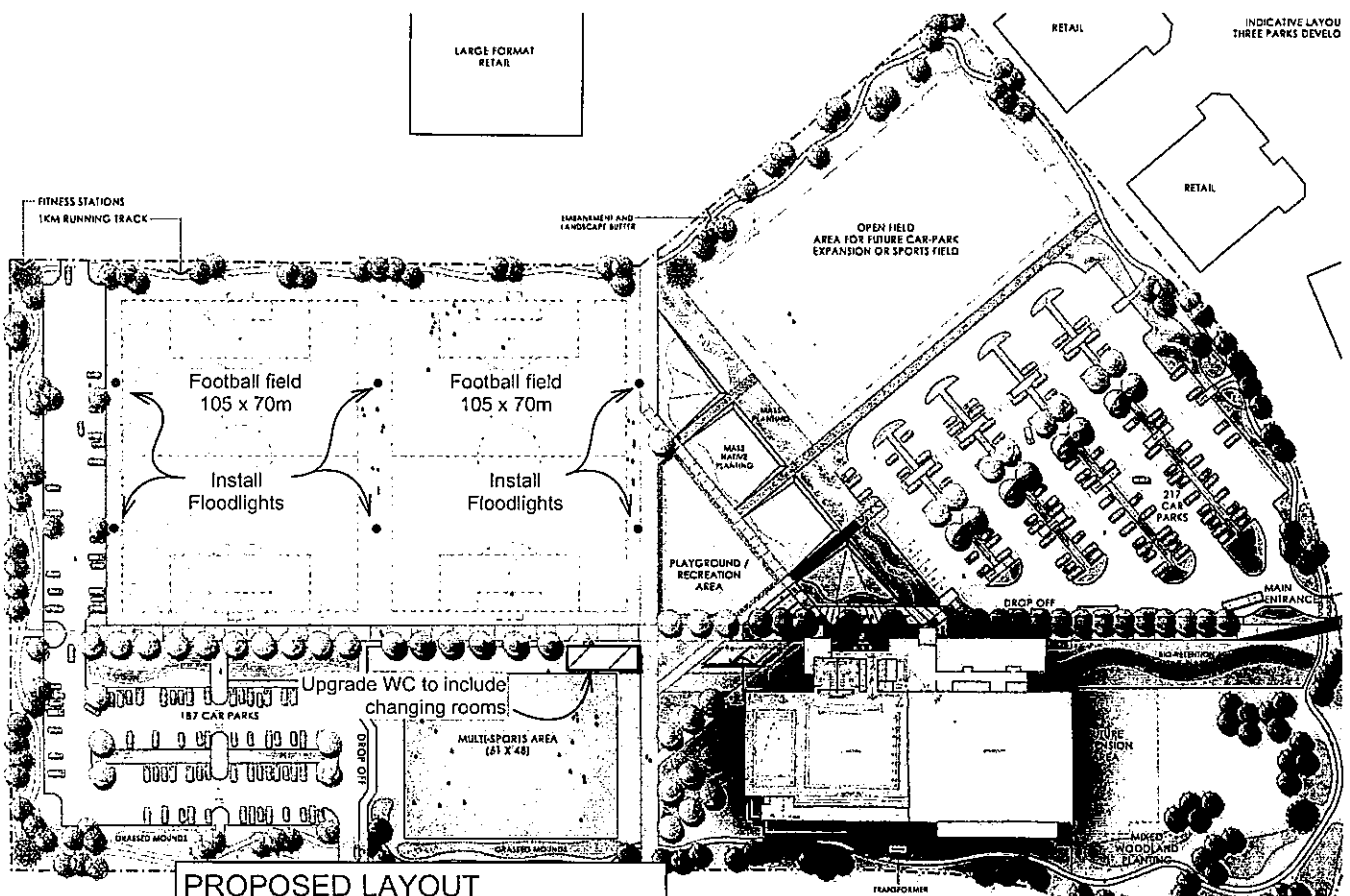

PROPOSED LAYOUT
WANAKA RECREATION CENTRE

3 October 2016

To Whom it may concern.

RE: Support for Wanaka Associated Football Club submission to the QLDC Annual Plan.

Submission Proposal: For QLDC to address the lack of sports field and sporting facilities in Wanaka

Central Otago Football Association (COFA) support the Wanaka Associated Football Clubs submission to the QLDC annual plan.

We agree that Wanaka needs better sports facilities to cater for the growth of football in Wanaka and the wider Central Otago District.

We support the development of a sports field area large enough to host regional tournaments in one location. The current situation of having tournaments spread across Wanaka is not ideal.

Yours sincerely,

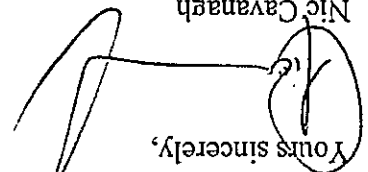

Nic Cavanagh

COFA President

Queenstown Associated Football Club
PO Box 2109, Queenstown, New Zealand
Email: info@queenstownfootball.com



19 October 2016

To Whom it may concern.

RE: Support for Wanaka Associated Football Club submission to the QLDC.

Submission Proposal: For QLDC to address the lack of sports field and sporting facilities in Wanaka

We the Queenstown Associated Football Club support the Wanaka Associated Football Clubs submission to the QLDC annual plan.

We travel to Wanaka during the junior football season to play in regional football competitions there, and we agree that Wanaka needs to address the current state of football fields in the town. The popularity of junior football in the region is growing fast and Wanaka needs better football fields to cater for this growth.

The present situation where games are played at two or three different venues across Wanaka is very inconvenient to parents that have children playing in different age groups, particularly when the weather is cold and wet as it often is in June and July. Add to this the lack of changing rooms and toilets particularly at Pembroke Park. The current situation is not ideal. It would be much improved if Wanaka could develop a football venue similar to Molyneux Park in Alexandra or the Event Centre in Queenstown. We support the development of a sports field area large enough to host regional tournaments in one location.

We also believe that Wanaka football fields needs better facilities and that the current state of the playing surface and grass maintenance needs serious addressing. In particular the football fields at Pembroke Park this year were in very poor condition.

Regards,

Dennis Dowling
QAFC President



4 November 2016
Paul Hodgson

To whom it may concern

On behalf of Me and the Wanaka Braves Football team, here are our point of reasons for the new Football facilities.

- Changing room and facilities
For the past 8 years I have played football in Wanaka, there has never been anywhere to get changed, go to the toilet or even fill a water bottle up. Every other club we play against has these facilities and it is an embarrassment to invite them over to play football. Changing rooms and toilets are essential.

- Floodlights
There are now over three Adult teams and four to six youth teams with no where to train at night. Being a ski resort we lose the precious sun Around 5pm in winter which is not ideal however this shouldn't prevent us from training. Currently we have been using the rugby grounds for the flood lit field and it is an absolute shambles to train on let alone safe. With out the use of flood lights how do you expect the young talents of Wanaka to improve. Floodlights are a must.

- High standard of maintenance
Over the last few years Pembroke park (current football field) has become more and more neglected and as a result of that there has been a number of injuries because of it. This needs to be stepped up at.

- More Football fields for the future.
Having the 2 new football fields in plan is fantastic all though we have pretty much out grown them all ready. Having a larger plot for the youth and junior teams to play on is the big picture. Having this will keep all football teams together. I can only imagine how frustrating it must be for parents with different age kids playing in different parts of Wanaka. Lets create a football hub where young athlete can grow and develop. We are a small town but punching way above our weight within our sports clubs. With out these kind of facilities these sport clubs will struggle to improve

Yours sincerely
Paul Hodgson
Wanaka Braves Manger

October 2016
Allan Carmichael
Manager/Coach/Player :- Wanaka A Football Club

To whom it may concern.

Topic.

The future of football and the facilities in relation to the growth and development of the sport in our town for all teams and age groups.

I have just completed my 7th season with Wanaka AFC, we compete in The Central Otago Football League. This consists of 3 teams from Wanaka alone, plus teams from Alexandra, Cromwell and Queenstown making up the 12 team league.

We punch well above our weight considering the size of our town and have won 3 league titles and a cup in the last 6 seasons, I feel we have helped contribute to the growth and development of football in the town.

In saying that, we are easily the most poorly equipped side/team to host games and offer training facilities/changing facilities/shelter/refreshments etc.

We literally have a poorly maintained patch of grass on Pembroke Park which has goal posts installed for the season and we pay a large sum of money for the privilege.

When daylight savings comes in to play in April we are forced to train at the rugby club as there are no floodlit facilities that offer an alternative.

The rugby grounds are not suitable for a number of reasons and whilst we really appreciate having somewhere to train, the grass is too long, there are no football goals and we have nowhere to change or shower.

On match days, whilst Pembroke is as beautiful a spot as any in the world to play, it offers next to nothing except a space to play.

The pitch has been poorly maintained for many years now and only last season our Youth team had to cut the grass THEMSELVES before a match in order for the game to go ahead.

I understand that there is no real scope to adapt Pembroke for footballing needs but once again it shows the real lack of depth and options for facilities in our town.

We are the only team in the league to offer no place to change, no place to shower, no shelter from the elements and little to no maintenance except for grass cutting occasionally.

For a town of our size and the projected growth of the sport in the future we need upgrades and soon. Compare our options to any other neighbouring town and we are lacking in the extreme.

The Events Centre in Queenstown, Molyneux Park in Alexandra and even Cromwell have better facilities currently including several, very well maintained, full size, grass football pitches with lighting.

I believe we have now overtaken all of our neighbouring towns in the number of children and youths taking up the sport, this stat in itself should rocket the priority of action needed to very urgent, we are talking about the future of our youngsters in this ever growing town.

Matters that need addressed regarding the future of football in Wanaka are:-

1. More pitches, many more pitches, full sized, grassed, irrigated and maintained by a grounds man. It would be beneficial to have a least one floodlit.
2. Full size, all weather, floodlit pitch for all age groups to utilise for training, especially in winter where the nights are dark early and grass pitches are harder to maintain....Everyone needs somewhere to train and practice. A 3/4 length pitch is not the solution and actually beggars believe that it is being installed as we speak.
3. Pembroke can fit 3 pitches running length way in the short term, lets make this happen.

To sum up, Wanaka and its economy are booming, the town will only increase in size and population in the coming years.
We need to think big, strategically and to the future, football is increasing in popularity and there is little to no facilities for any age groups currently.
We need to encourage the development of the game and make Wanaka a central hub in Otago to come and play the sport, that means nice facilities to train and play on, a place to change and shower after matches and sessions and people with a keen interest in maintaining the grounds.

Regards

Allan Carmichael

Wanaka AFC

Manager/Coach/player/Football lover

0210410618

Allancarmichael61080@hotmail.com

To: - QLDC -

From: United Youth Voice

Date: 30th November 2016

MURAL

There is no account of the Legend of the Lake in Queenstown. We believe that Queenstown needs to showcase our unique Maori culture and heritage by getting youth to design and paint an illustrated story of the legend of the lake along the beach front wall (the wall that goes from the Kawarau Jet wharf to the memorial gates). The wall as it stands is plain concrete and not very interesting, so we believe that it will also make the beachfront more interesting and colourful.

A way of doing this could be to run an art competition amongst youth to create the design for this mural, the winner will paint the wall with a professional artist to make the wall vibrant, interesting and informative. This means that youth will be actively involved in the improvement of the lakeside, along with providing youth with opportunities to showcase their talents. We believe that this mural will add to Queenstown's vibrant culture and will be enjoyed by locals and tourists alike.

SENSORY GARDEN

In order to attract more families and children to the gardens we believe that there should be a kids 'Sensory Garden' which not only will provide entertainment for youth in the gardens, but will be useful in teaching youth about nature. These sorts of gardens contain plants that are colourful and look good (e.g. marigolds, peonies), that smell nice (e.g. lavender, jasmine), that have different textures (e.g. lamb's ear). If youth are involved in planting the space it will further encourage them to get outdoors and be involved in our own. This space will create a fun and enjoyable environment for children of all ages to interact with the environment.

SUBMISSION FORM FEES & CHARGES REVIEW

(PLANNING & DEVELOPMENT)



TO // Queenstown Lakes District Council

YOUR DETAILS

Your Name: *Valerie Parker* *Bonnie Grummett* *Richard Grimme*

Email Address: [preferred method of contact]

Postal Address: [if no email is provided]

48 Russell Street *22 Russell St* *22 Russell St*
Wanaka *Wanaka*

Telephone Number: *03 443 8206* *443 7748* *443 7748*

Mobile Number:

JANE KUZMA
4 RUSSELL ST
WANAKA 4431771

SUBMISSION

Community Park

☒ I Support ☒ Oppose the application *"Sports ground park"*

☒ I Do ☒ Do not wish to be heard in support of my submission

SIGNATURE

Signature **

Valerie E. Parker *Grummett* *Grimme*

Date *30/11/2016* *1/12/16* *1/12/16*

** If this form is being completed on-line you may not be able, or required, to sign this form.



Private Bag 50072, Queenstown 9348
10 Gorge Road, Queenstown 9300
47 Ardmore Street, Wanaka

P: QUEENSTOWN 03 441 0499
P: WANAKA 03 443 0024
E: feesandcharges@qldc.govt.nz W: www.qldc.govt.nz



MY SUBMISSION IS // The particular parts of the application I support or object to are:

Parks & Open Space Strategy

I submit that the penbroke park be
known as Community only

Community Park

Valerie Parker



MY SUBMISSION WOULD BE MET BY THE QUEENSTOWN LAKES DISTRICT COUNCIL MAKING THE FOLLOWING DECISION // Include any conditions sought:



**QUEENSTOWN
LAKES DISTRICT
COUNCIL**

Private Bag 50072, Queenstown 9348
10 Gorge Road, Queenstown 9300
47 Ardmore Street, Wanaka

P: QUEENSTOWN 03 441 0499
P: WANAKA 03 443 0024
E: feesandcharges@qldc.govt.nz W: www.qldc.govt.nz